

■ AUTOMATIC TRANSMISSION BREATHER SYSTEM

- An automatic transmission breather system is adopted, helping to avoid loss of ATF from the breather during sporty driving involving quick turns and rapid braking.
- This system uses the labyrinthine structure of the breather tube to separate bubbles made up of air and ATF into air and liquid, preventing loss of ATF using the breather tank.

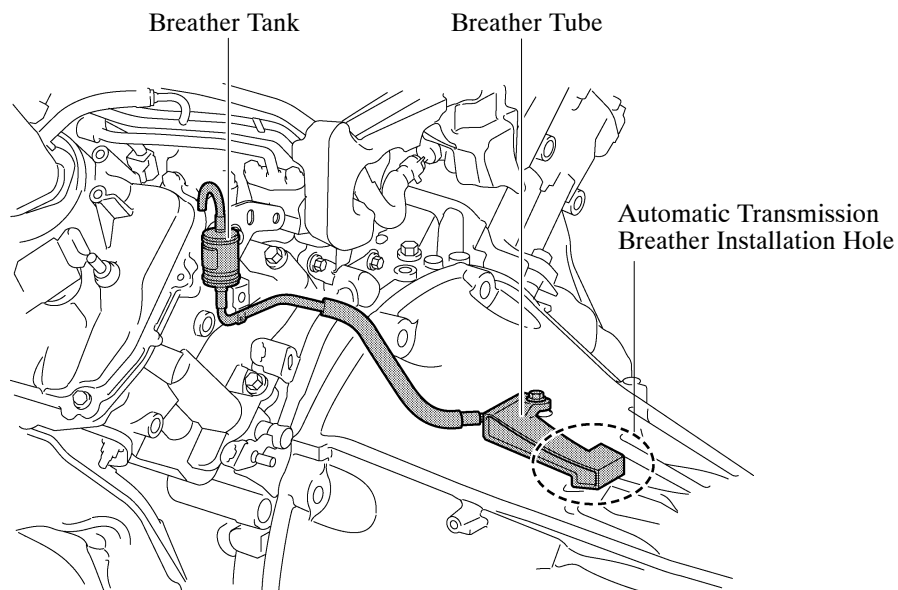

08D0CH16C

■ ATF COOLER

An air-cooled type ATF cooler is used to ensure ATF cooling performance for sporty driving.

- ATF discharged from the automatic transmission is cooled when passing through the water-cooled ATF cooler in the radiator and the air-cooled type ATF cooler. After ATF is cooled, it returns to the automatic transmission.

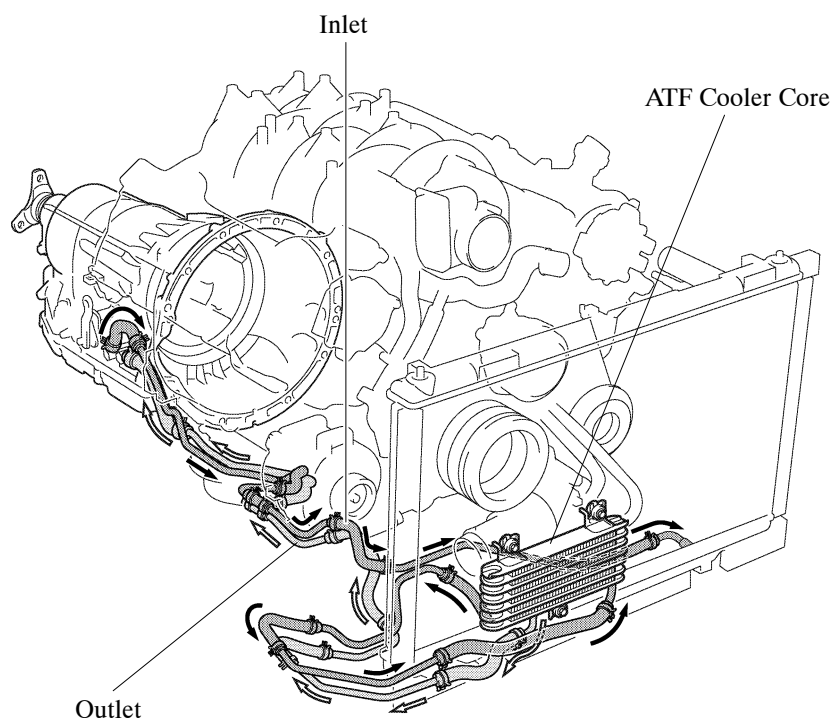

08D0CH14C