

IS F

OUTLINE OF NEW FEATURES

The following changes have been made for the new IS F.

1. Exterior Color

A total of 7 exterior colors; 6 carryover colors and 1 new color, are available for standard models.

Color No.	Color Name	Note
077	White Pearl Crystal Shine	Carryover
1F2	Premium Silver	Carryover
1H9	Mercury Gray Mica	New
212	Black	Carryover
217	Starlight Black Glass Flake	Carryover
3R1	Red Mica Crystal Shine	Carryover
8U1	Exceed Blue Metallic	Carryover

2. Tire and Wheel

A new wheel design has been added.

☐ : Added

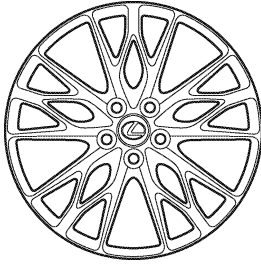
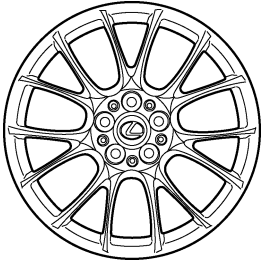
Tire Size	Front		225/40 R19	225/40 R19
	Rear		255/35 R19	255/35 R19
Wheel	Size	Front	19 × 8J	19 × 8 1/2J
		Rear	19 × 9J	19 × 9 1/2J
	Material		Aluminum	Aluminum
	Color (Color No.)		Dark Silver Metallic (11GY39)	Dark Silver Metallic (11GY39)
P.C.D.*	mm (in.)		114.3 (4.5)	114.3 (4.5)
Inset	mm (in.)	Front	45 (1.8)	45 (1.8)
		Rear	55 (2.2)	51 (2.0)
Wheel Design			 13V0NF14C	 18Y0IN01C
Equipment			Standard	Option

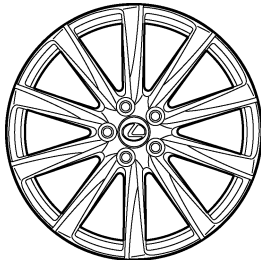
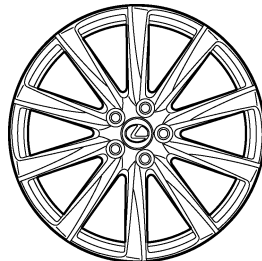
Tire Size	Front		225/40 R19		
	Rear		255/35 R19		
Wheel	Size	Front	19 × 8J		
		Rear	19 × 9J		
	Material		Aluminum		
	Color (Color No.)		Dark Silver Metallic (11GY39)	Silver (11GY38)/Buffed Finish	
P.C.D.*	mm (in.)		114.3 (4.5)		
Inset	mm (in.)	Front	45 (1.8)		
		Rear	55 (2.2)		
Wheel Design		Left Side:		Right Side:	
					
		13V0NF12C		13V0NF13C	
Equipment		Option			

*: P.C.D. (Pitch Circle Diameter)

3. Interior

- The interior color has been added. For details, [see page 7](#).
- The head restraints for the outer rear seats have been changed to a foldable type.

4. Electronic Control System for Automatic Transmission

The location of the SNOW mode switch has been changed.

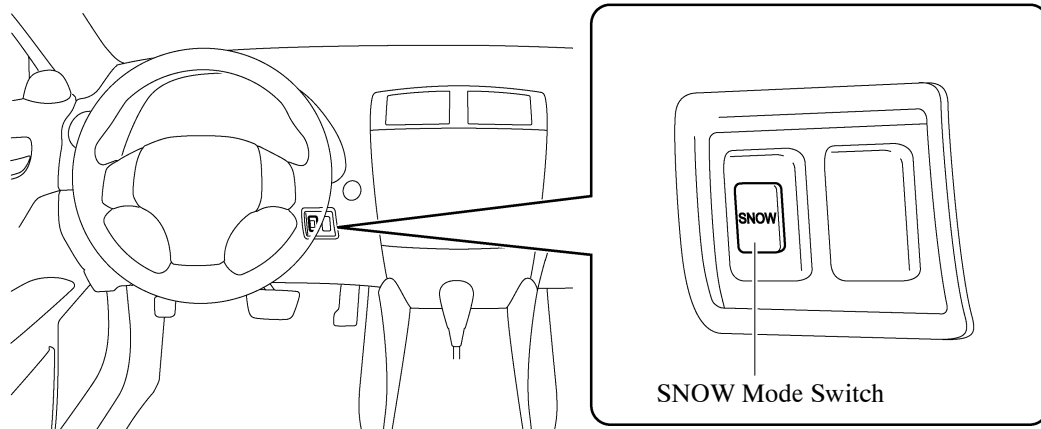

18Y01N02C

5. Suspension

- The spring constant of each front and rear suspension spring has been changed to ensure responses while steering.
- The front and rear shock absorbers have been changed to ensure responses while steering and road holding ability. For details, [see page 8](#).
- The shape of the rear spring bumper has been changed to ensure driving comfort. For details, [see page 8](#).
- Due to the changes above, the wheel alignments have been changed as follows:

Front Suspension Type			Double-wishbone
Front Wheel Alignment	Tread*1	mm (in.)	1560 (61.4)
	Caster*1	degrees	8.7°
	Camber*1	degrees	- 0.87°
	Toe-in*1	mm (in.)	0.18 (0.007)
	King Pin Inclination*1		11.18°
Rear Suspension Type			Multi-link
Rear Wheel Alignment	Tread*1	mm (in.)	1520 (59.8), 1530 (60.2)*2
	Camber*1	degrees	- 1.5°
	Toe-in*1	mm (in.)	3.0 (0.12)

*1: Unloaded Vehicle Condition

*2: Models with 19 × 9 1/2J Wheels

6. Brake

The location of the VSC OFF switch has been changed.

► LHD Models ◀

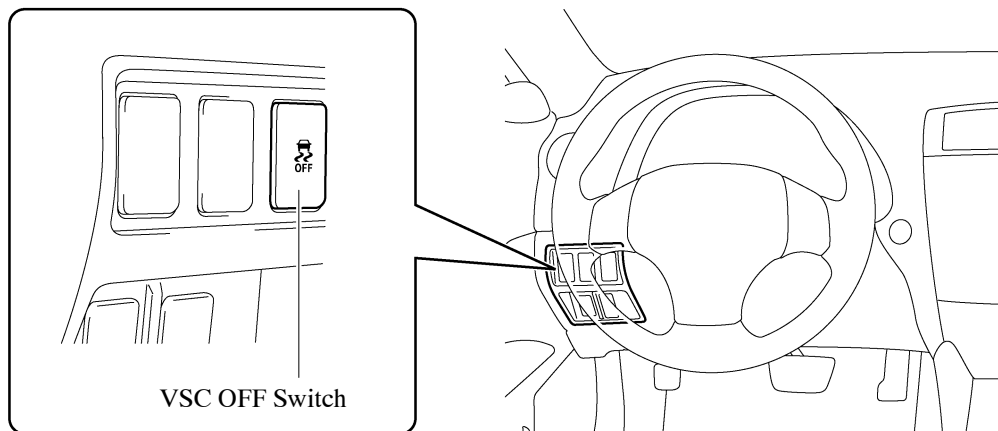

18Y0IN03C

► RHD Models ◀

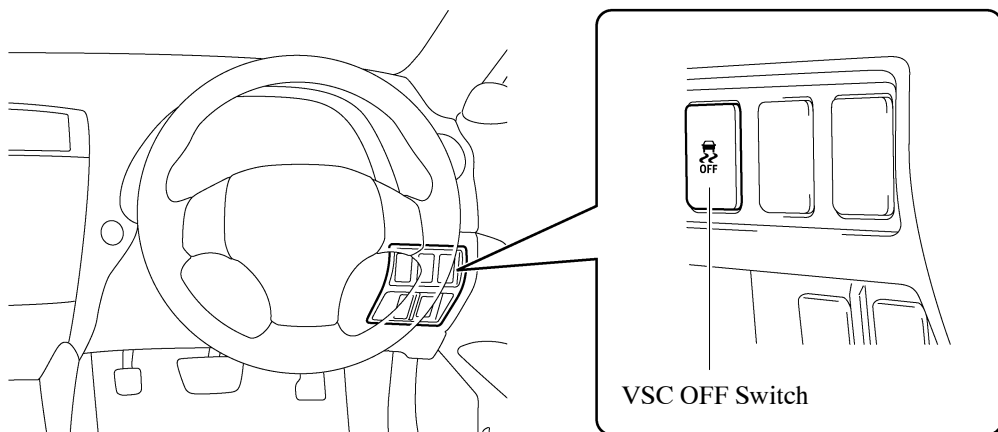

08E4IN01C

- The fail-safe function operated when a malfunction is detected in communication between the skid control ECU assembly and ECM or detected in engine control has been changed as follows:

Function	New Models	Previous Models
Fail-safe	Skid control ECU assembly stops TRC and Hill-start Assist Control.	Skid control ECU assembly stops TRC, VSC and Hill-start Assist Control.

7. Multiplex Communication

The following customizable item for the door lock system has been changed. For details, [see page 11](#).

- All Unlock/Open-Close

8. Front Wiper Deicer System

The location of the front wiper deicer switch has been changed.

