

BODY PANEL SEALING AREAS

- 1 Be sure to apply body sealer to the body panel joints and door edges (tip of outer panel folded part), etc., to waterproof and rustproof them.

HINT:

- Apply degreasing agent to a clean cloth and clean the sealer application areas.
- After removing the applied spot sealer from the sealer application areas using thinner or equivalent, rustproof the areas by applying primer or equivalent. Then apply body sealer.
- If sealer is unnecessarily applied to an area, apply degreasing agent to a clean cloth and clean off the sealer immediately.

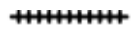

Flat Finishing



No Flat Finishing

1. ENGINE COMPARTMENT

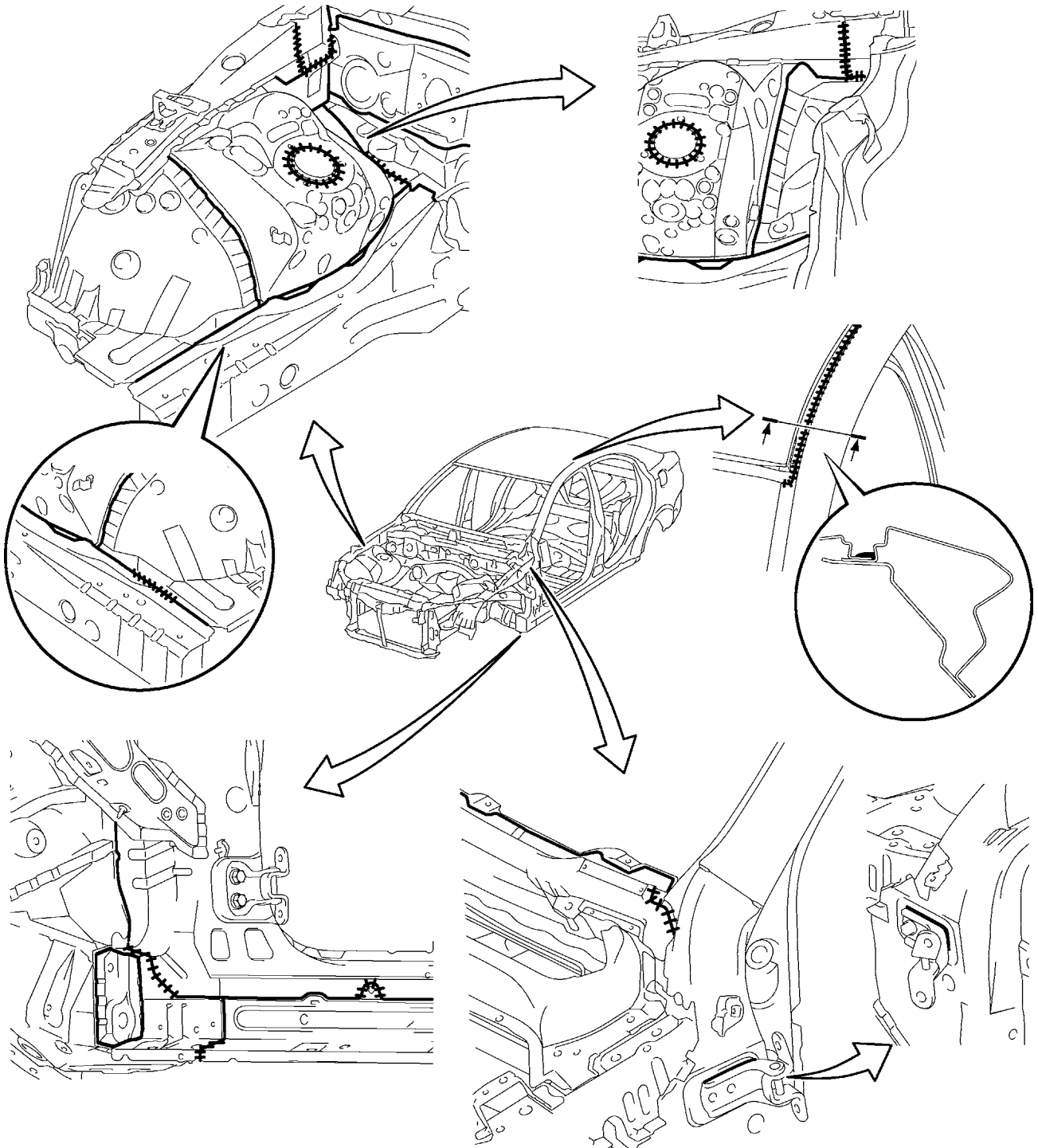

2. INSIDE

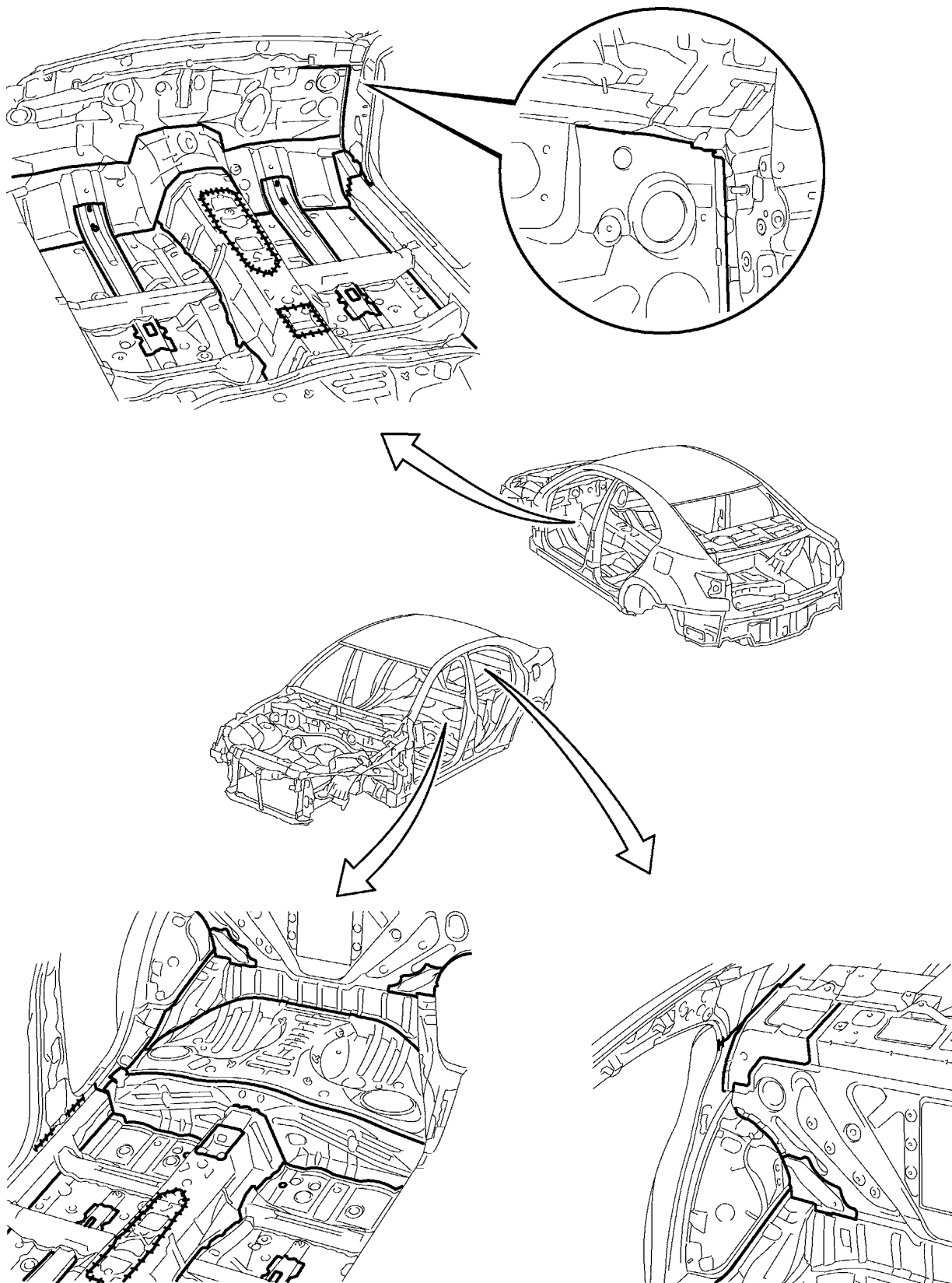

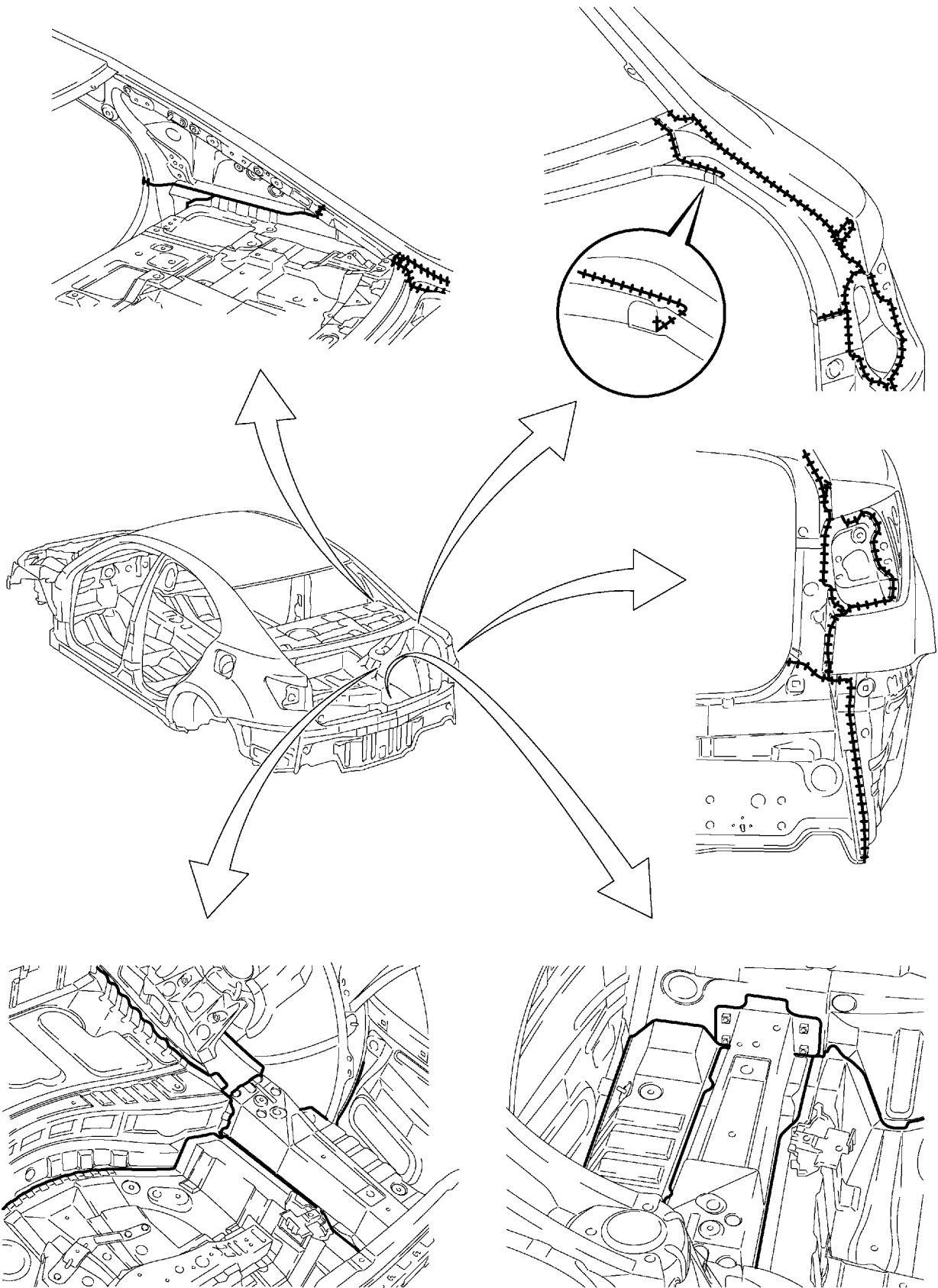
3. OUTSIDE

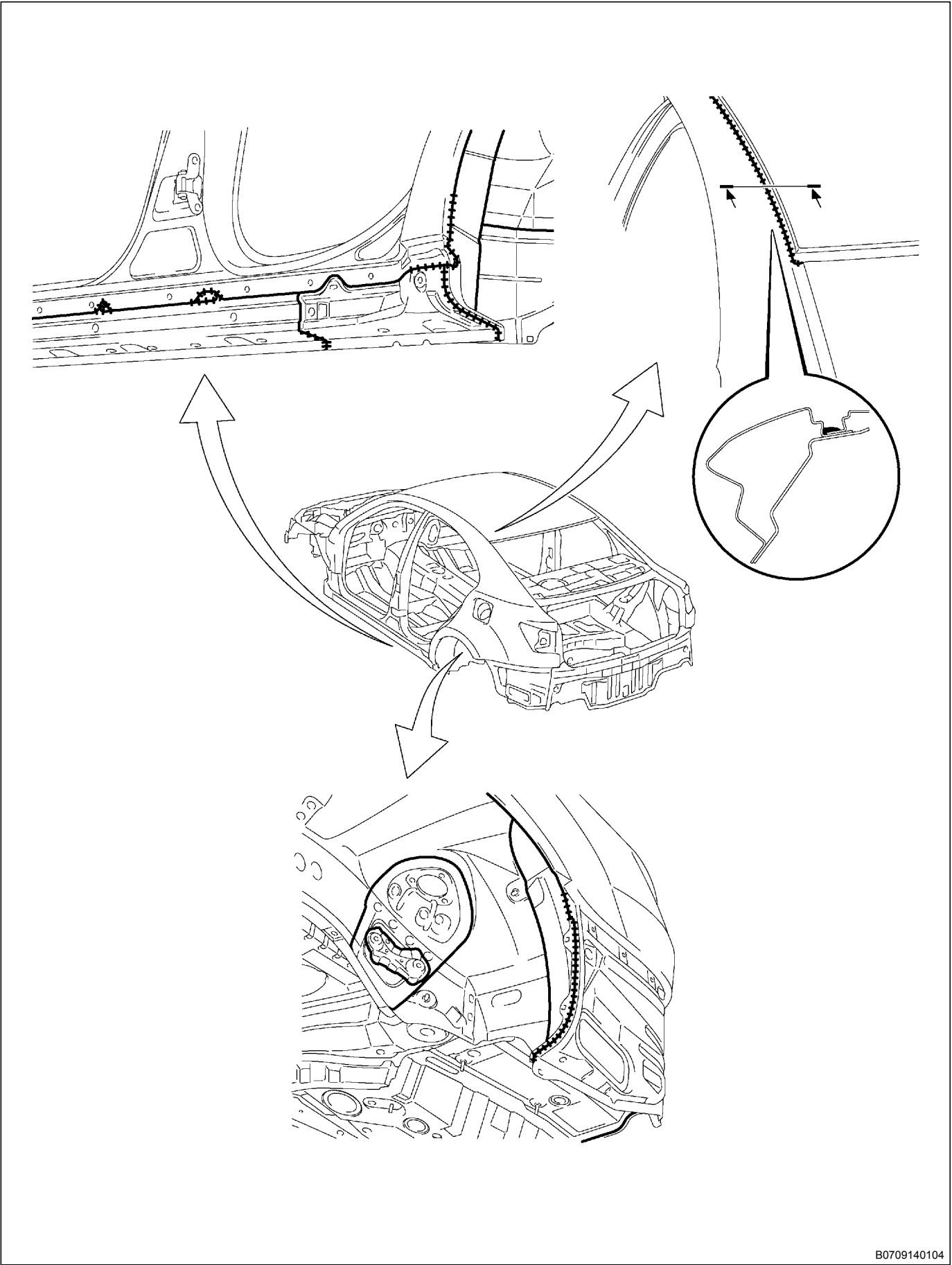

4. DOOR PARTS