

QUARTER WHEEL HOUSE OUTER PANEL (ASSY)

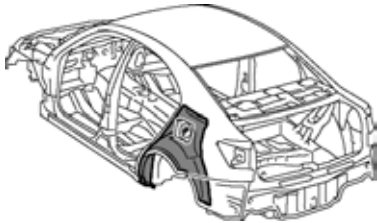

B0709140123

With the quarter panel removed.

Symbol meaning

REMOVAL

△ △ △ : Remove Weld Points S : Cut and Join Location

INSTALLATION

○ T M : MIG Plug Weld ⊙ : Spot MIG Weld

⏏ : Butt Weld

REMOVAL-INSTALLATION

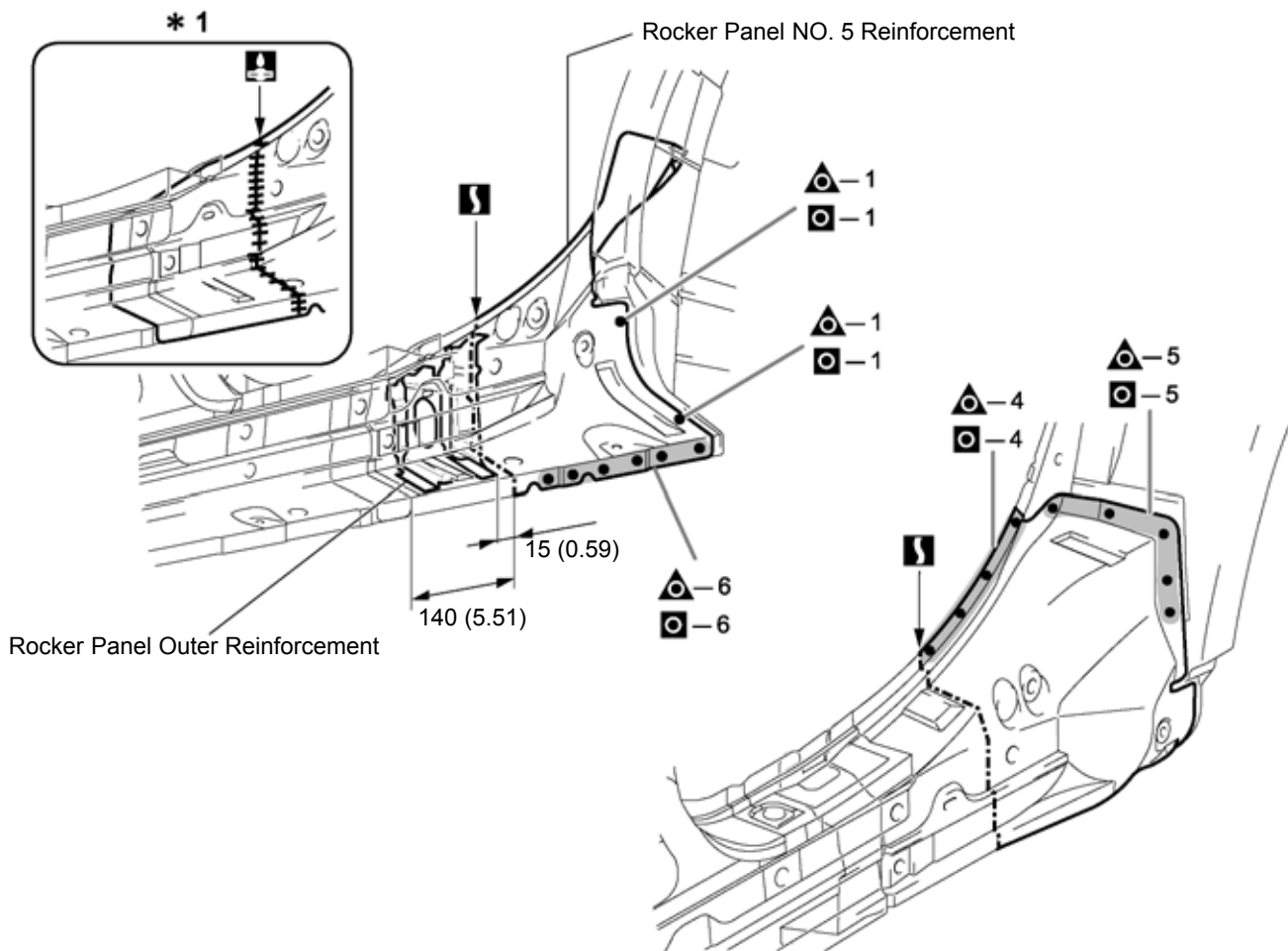

mm (in.)

B0709140142

REMOVAL POINT

- 1 Remove rocker panel NO. 5 reinforcement, then remove quarter wheel house outer panel.
- 2 Carefully cut the rocker panel NO. 5 reinforcement so not to damage the internal rocker panel outer reinforcement.

INSTALLATION POINT

- 1 After installed quarter wheel house outer panel, install rocker panel NO. 5 reinforcement.
- 2 *1 indicates installation work.
- 3 After welding, apply body sealer and undercoating to the corresponding parts. (See the paint-coating)
- 4 After applying the top coat, apply anti-rust agent to the internal panel portion of the closed section structural weld points.

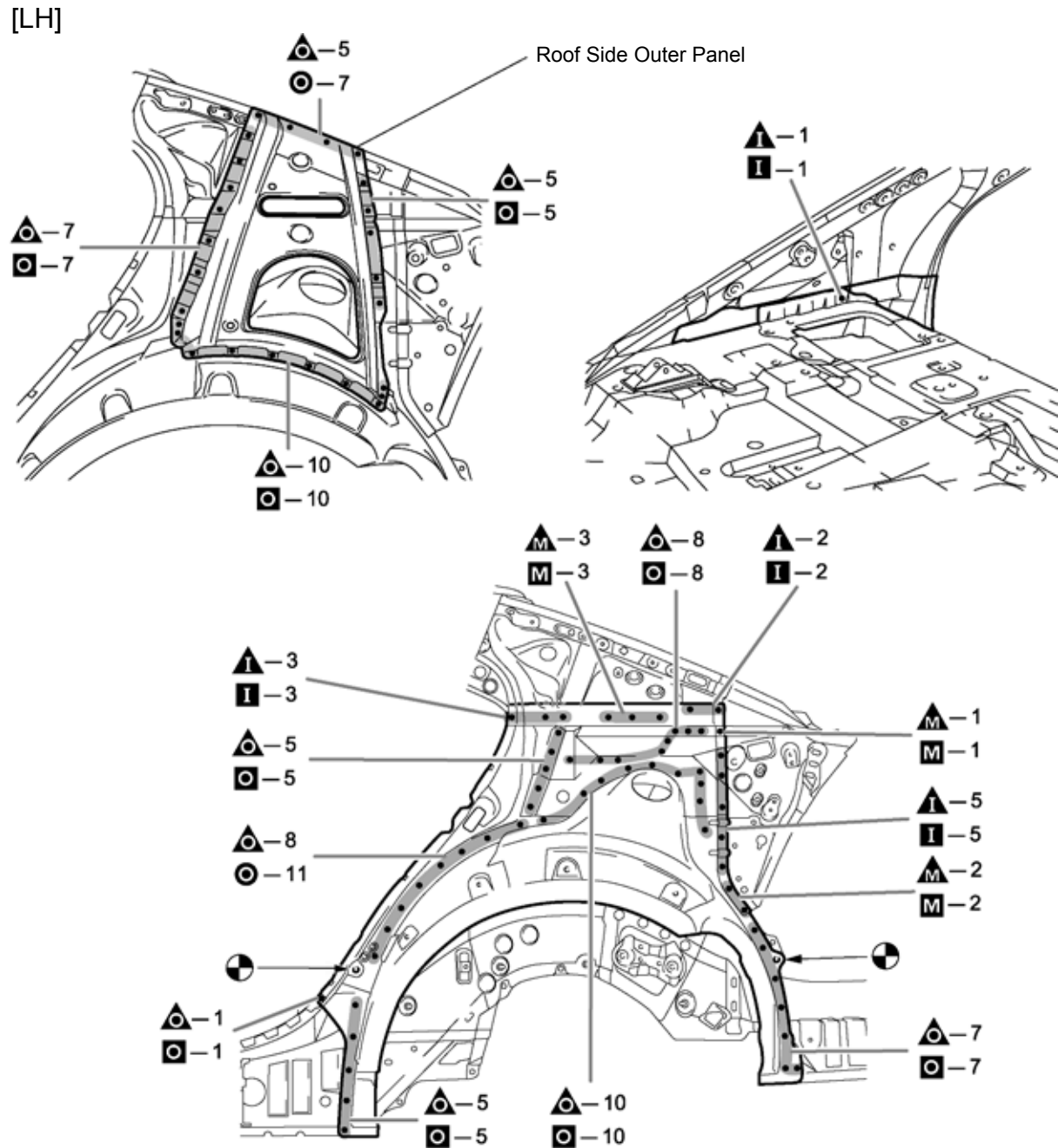

B0709140143





REMOVAL POINT

- 1 Remove roof side outer panel, then remove quarter wheel house outer panel.

INSTALLATION POINT

- 1 For positioning of the new parts, the installation standard holes of the Outer panel and the Inner panel shall be matched.
- 2 *1 indicates installation work.
- 3 After welding, apply body sealer and undercoating to the corresponding parts. (See the paint-coating)
- 4 After applying the top coat, apply anti-rust agent to the internal panel portion of the closed section structural weld points.

Symbol meaning

REMOVAL    : Remove Weld Points  : Cut and Join LocationINSTALLATION    : MIG Plug Weld  : Spot MIG Weld  : Butt Weld

[RH]

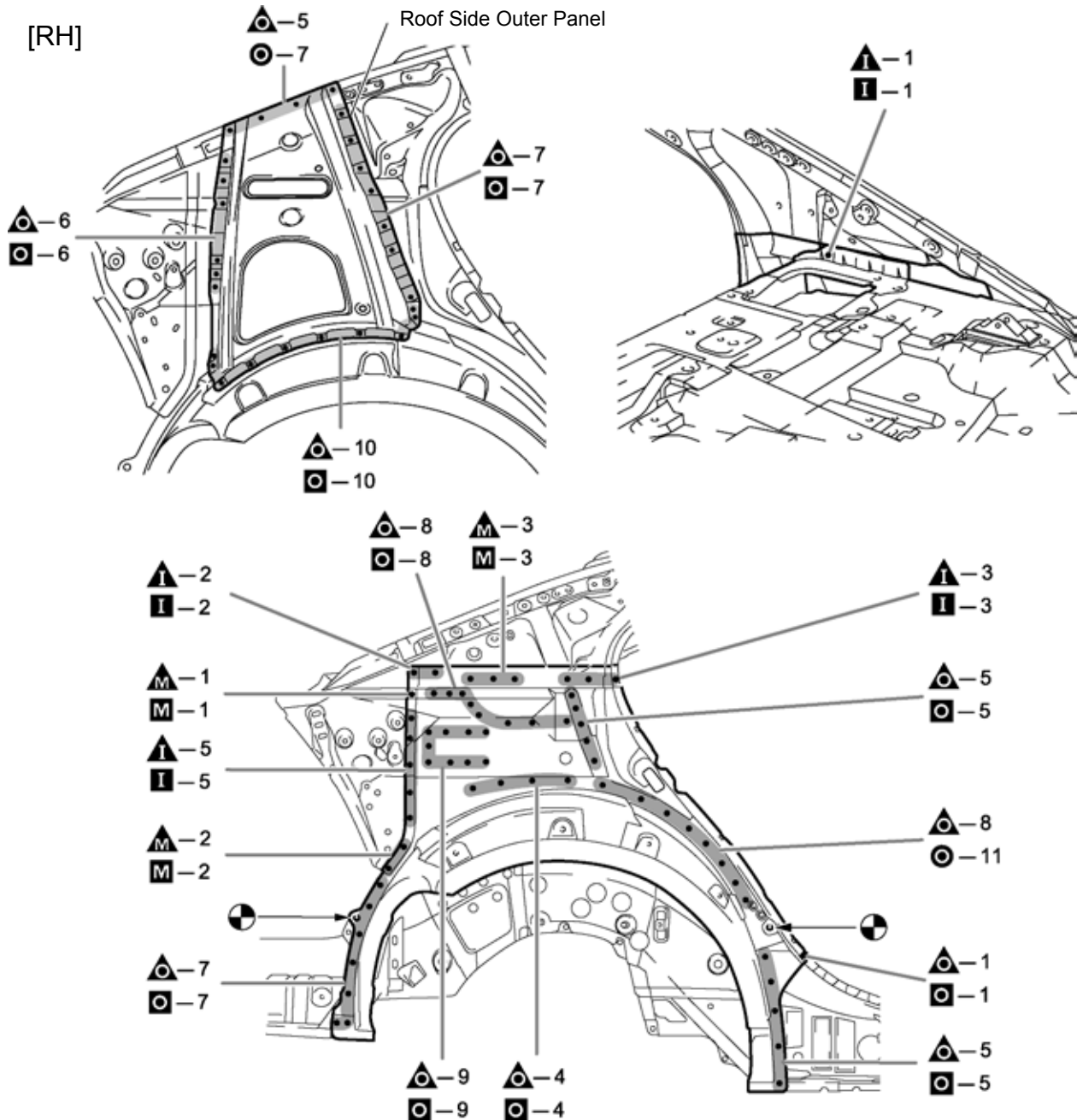

B0709140144A

REMOVAL POINT

- 1 Remove roof side outer panel, then remove quarter wheel house outer panel.

INSTALLATION POINT

- 1 For positioning of the new parts, the installation standard holes of the Outer panel and the Inner panel shall be matched.
- 2 *1 indicates installation work.
- 3 After welding, apply body sealer and undercoating to the corresponding parts. (See the paint-coating)
- 4 After applying the top coat, apply anti-rust agent to the internal panel portion of the closed section structural weld points.