

ROCKER PANEL NO. 5 REINFORCEMENT (CUT)

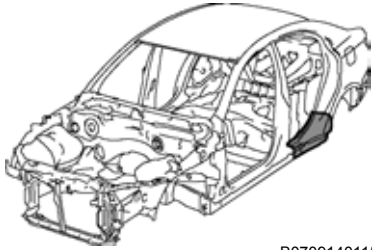

B0709140115

Symbol meaning

△ : Remove Weld Points S : Cut and Join Location

REMOVAL

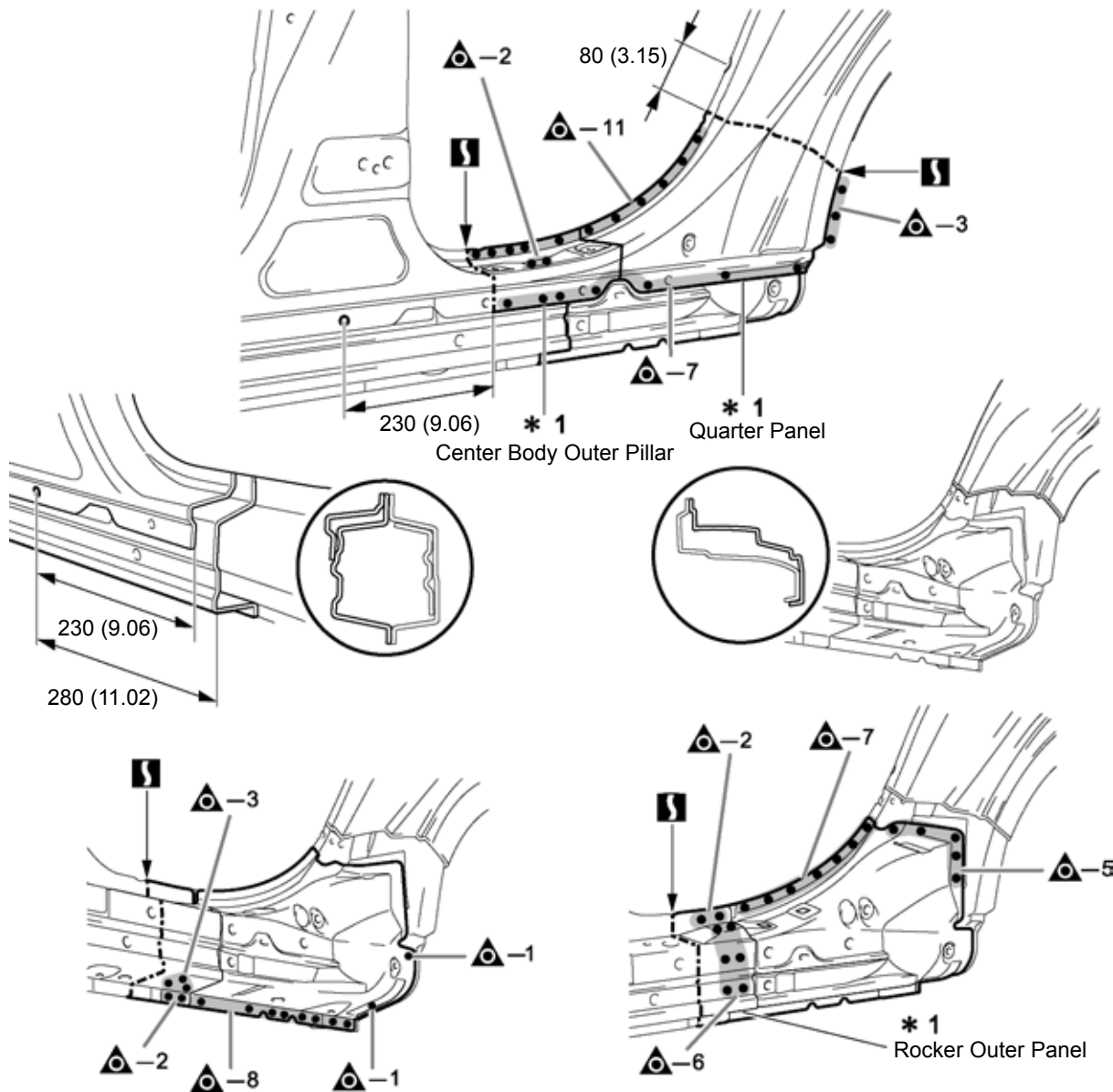

mm (in.)

B0709140135

REMOVAL POINT

- 1 Remove the rocker outer panel at the same time.
- 2 *1 is reused.

Symbol meaning

◻ : MIG Plug Weld ◻ : Butt Weld

INSTALLATION

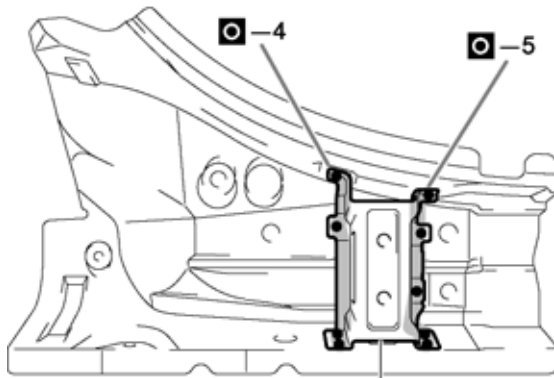

Rocker Panel Outer Reinforcement

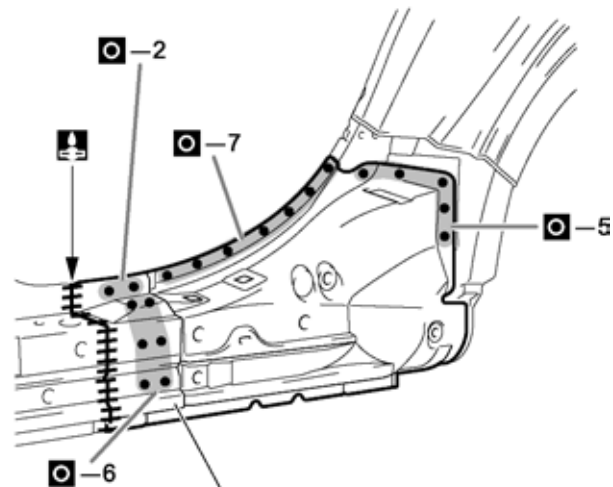

Rocker Outer Panel

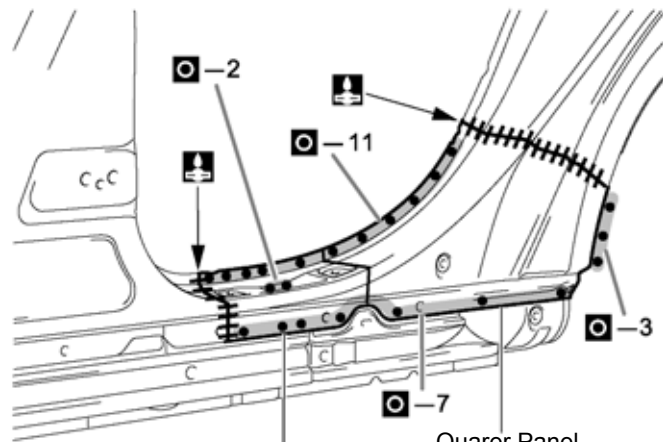
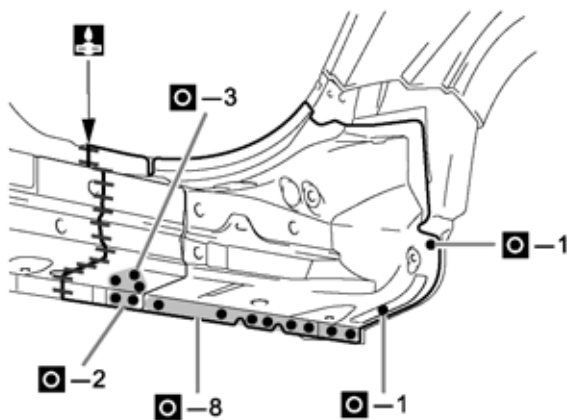

Center Body Outer Pillar

Quarter Panel

B0709140136

INSTALLATION POINT

- 1 Temporarily install the new parts and measure each part of the new parts in accordance with the body dimension diagram. (See the body dimension diagram)
- 2 Inspect the fitting of the related parts around the new parts before welding. This affects the appearance of the finish.
- 3 After welding, apply polyurethane foam to the corresponding parts. (See the paint-coating)
- 4 After welding, apply body sealer and undercoating to the corresponding parts. (See the paint-coating)
- 5 After applying the top coat, apply anti-rust agent to the internal panel portion of the closed section structural weld points.