

## FRONT SIDE MEMBER (CUT)

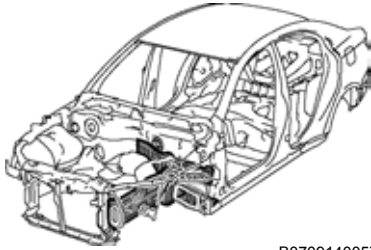

B0709140057

With the front fender apron removed.

### Symbol meaning

REMOVAL

INSTALLATION

▲ ▲ ▲ : Remove Weld Points

⌋ : Cut and Join Location

○ T M : MIG Plug Weld    ◻ : Butt Weld

### REMOVAL-INSTALLATION

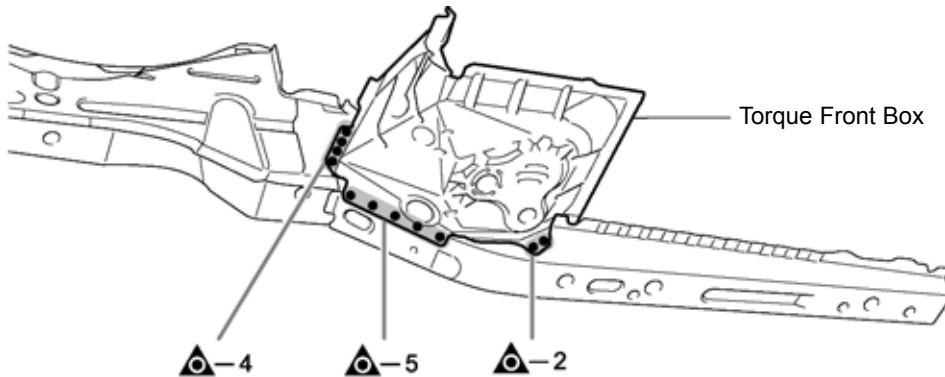

[RH]

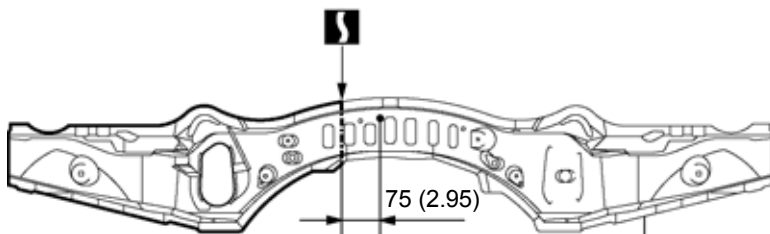

[LH]

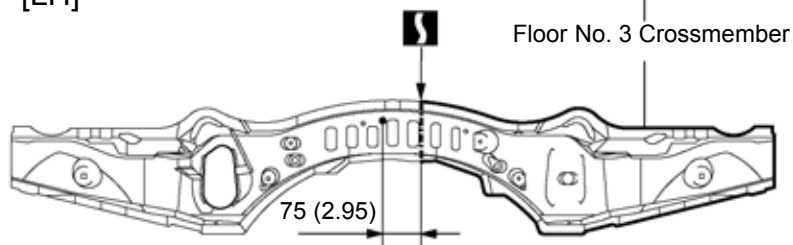

Floor No. 3 Crossmember

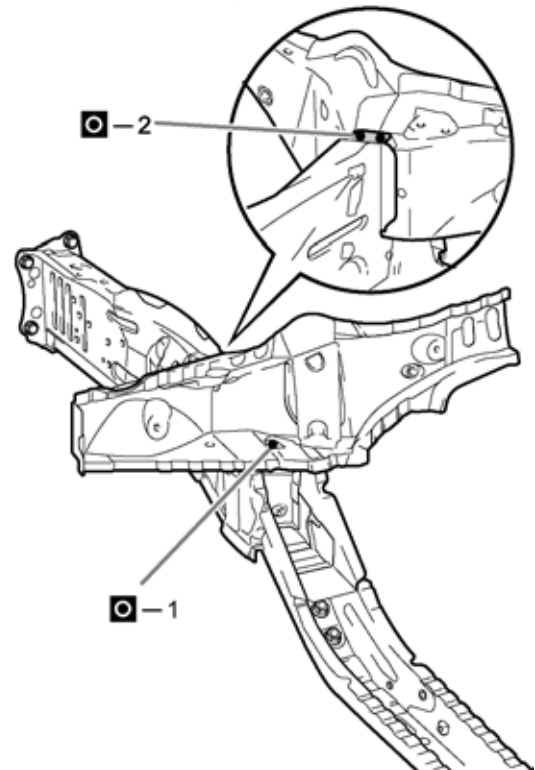

mm (in.)

B0709140058

### REMOVAL POINT

- 1 Remove the torque front box from the new parts of the front side member.
- 2 Cut the new floor No. 3 crossmember part as illustrated above, and then properly assemble and install the new front side member part in accordance with the body dimensions.

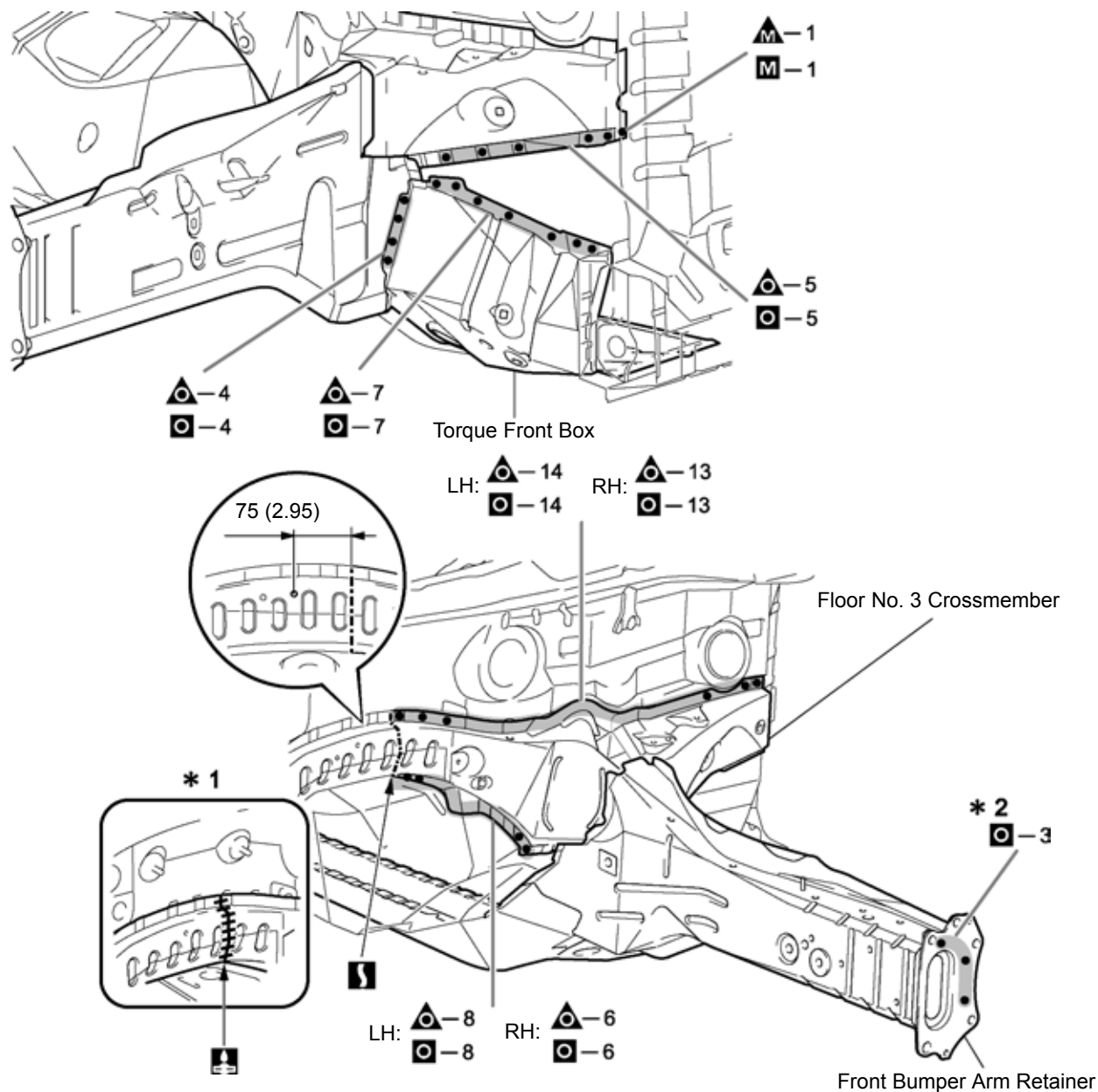

B0709140059

**REMOVAL POINT**

- 1 Remove the torque front box first, then remove the front side member.
- 2 Remove the floor No. 3 crossmember at the same time.

**INSTALLATION POINT**

- 1 \*1 shows installation work.
- 2 After welding, apply body sealer and undercoating to the corresponding parts. (See the paint-coating)
- 3 After applying the top coat, apply anti-rust agent to the internal panel portion of the closed section structural weld points.
- 4 \*2 is only necessary for installation.

## Symbol meaning

REMOVAL         : Remove Weld Points       : Cut and Join Location       : Cut with Disc Sander etc.

INSTALLATION         : MIG Plug Weld       : Butt Weld

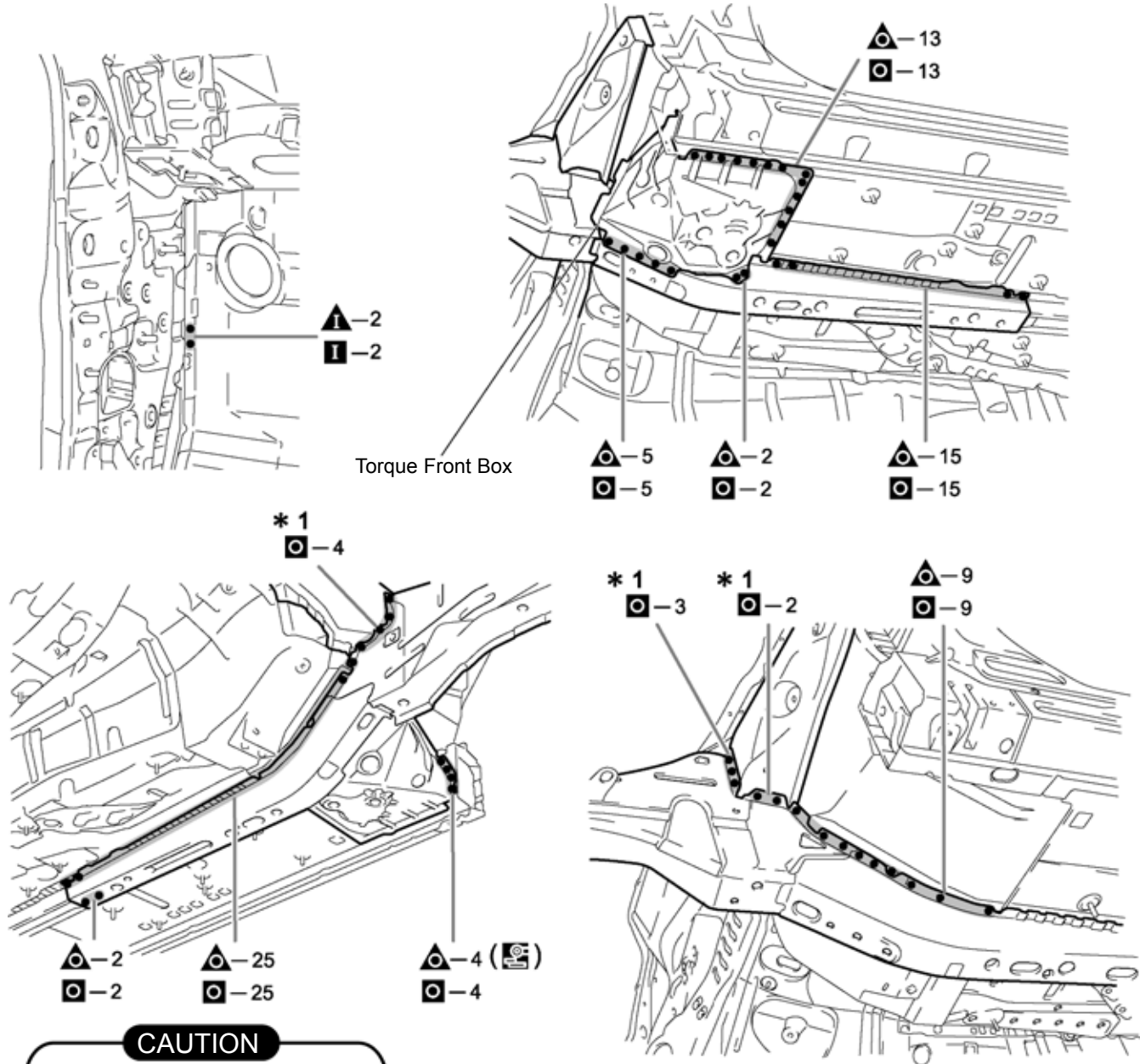

B0709140060

## INSTALLATION POINT

- 1 \*1 is only necessary for installation.
- 2 After welding, apply body sealer and undercoating to the corresponding parts. (See the paint-coating)
- 3 After applying the top coat, apply anti-rust agent to the internal panel portion of the closed section structural weld points.