

REMOVAL

1. REMOVE REAR WHEEL
2. REMOVE REAR FENDER APRON SEAL

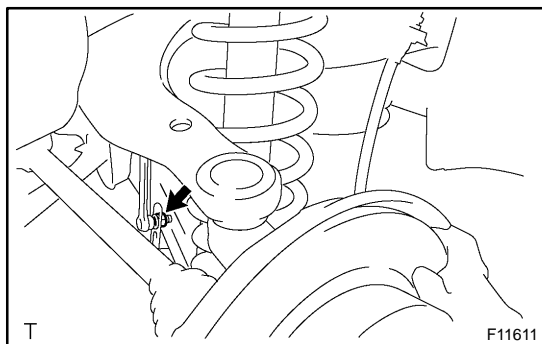

3. DISCONNECT HEIGHT CONTROL SENSOR LINK

Remove the nut and disconnect the height control sensor link from lower arm bracket.

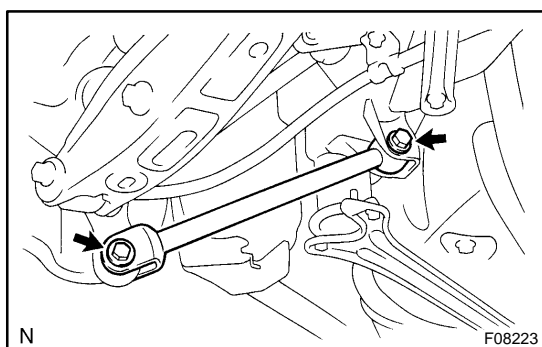

4. REMOVE NO. 1 LOWER SUSPENSION ARM

Remove the 2 bolts, nuts, and No. 1 lower suspension arm.

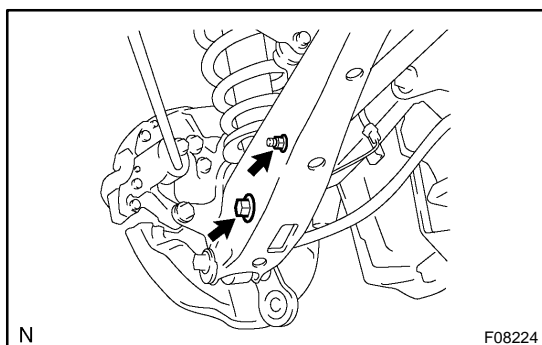

5. REMOVE NO. 2 LOWER SUSPENSION ARM

- (a) Remove the nut, bolt and bracket, and disconnect the stabilizer bar link from the No. 2 lower suspension arm.
- (b) Remove the bolt and nut, and disconnect the shock absorber from the No. 2 lower suspension arm.
- (c) Place matchmarks on the cam bolt and No. 2 lower suspension arm.
- (d) Remove the nut, cam plate and cam bolt, and disconnect the axle carrier.

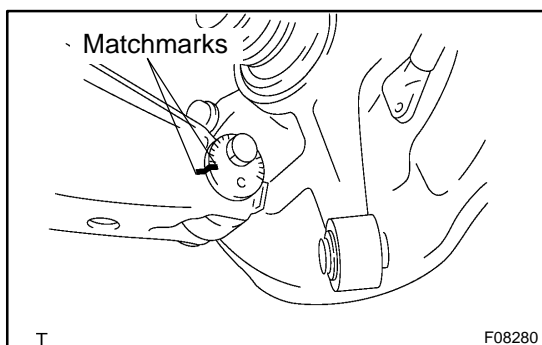

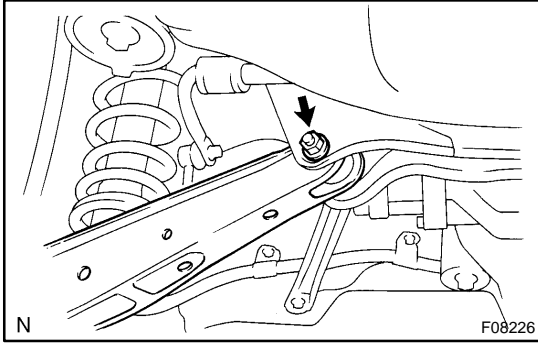

- (e) Remove the nut, washer, bolt and No. 2 lower suspension arm from the rear suspension member.