

## INSTALLATION

### NOTICE:

Never use airbag parts removed from another vehicle.  
When replacing parts, replace them with new parts.

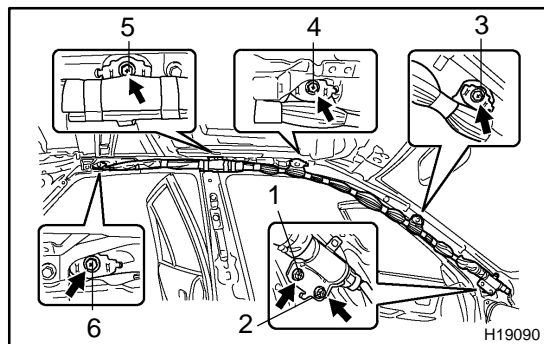

### 1. INSTALL CURTAIN SHIELD AIRBAG ASSEMBLY

- (a) In order shown in the illustration, install the curtain shield airbag assembly with the 6 bolts.

**Torque: 9.8 N·m (100 kgf·cm, 86 in.-lbf)**

### CAUTION:

Pay attention not to twist the deployment section of the curtain shield airbag assembly.

### NOTICE:

- Make sure that the curtain shield airbag assembly is installed with the specified torque.
  - If the curtain shield airbag assembly has been dropped, or any cracks, dents or other defects in the case or connector, replace the curtain shield airbag assembly with a new one.
  - When installing the curtain shield airbag assembly, be careful to prevent it from being pinched between other parts.
- (b) Connect the connector of the curtain shield airbag assembly.

### 2. INSTALL INSTRUMENT PANEL (See page [BO-149](#))

### 3. When inflator is installed:

### INSTALL CURTAIN SHIELD AIRBAG ASSEMBLY

In order shown in the illustration, install the deployment section of the curtain shield airbag assembly with the 4 bolts.

**Torque: 9.8 N·m (100 kgf·cm, 86 in.-lbf)**

### CAUTION:

Pay attention not to twist it.

### NOTICE:

- Make sure that the curtain shield airbag assembly is installed with the specified torque.
- When installing the curtain shield airbag assembly, be careful to prevent it from being pinched between other parts.

### 4. INSTALL ROOF HEADLINING

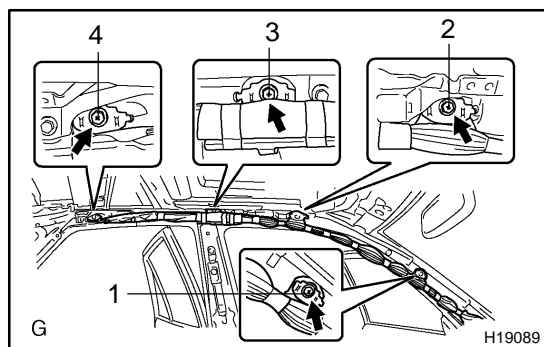

Pages for reference	See page
Sedan	<a href="#">BO-160</a>
Wagon	<a href="#">BO-169</a>