

REMOVAL

NOTICE:

- If the wiring connector of the SRS is disconnected and the ignition switch is at ON position, DTCs will be recorded.
- Never use any airbag parts removed from another vehicle. When replacing parts, replace them with new ones.

1. REMOVE ROOF HEADLINING

Pages for reference	See page
Sedan	BO-156
Wagon	BO-164

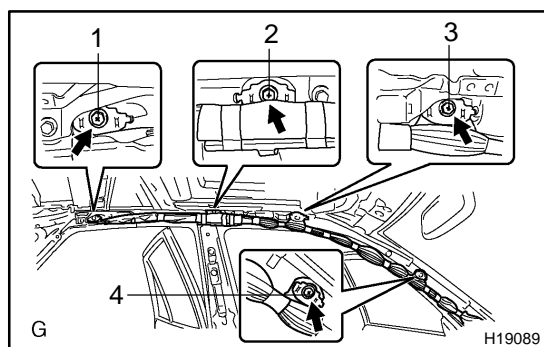

2. In case without removing inflater:

REMOVE CURTAIN SHIELD AIRBAG ASSEMBLY

- (a) In the order shown in the illustration, remove the bolts and deployment section of the curtain shield airbag assembly.

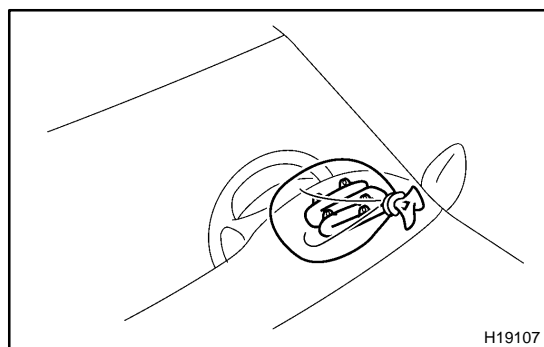

- (b) Put the removed curtain shield airbag assembly into a clear plastic bag and put it on the instrument panel.

CAUTION:

Never disassemble the curtain shield airbag assembly.

NOTICE:

The clear plastic bag is not reusable.

3. REMOVE INSTRUMENT PANEL (See page [BO-139](#))

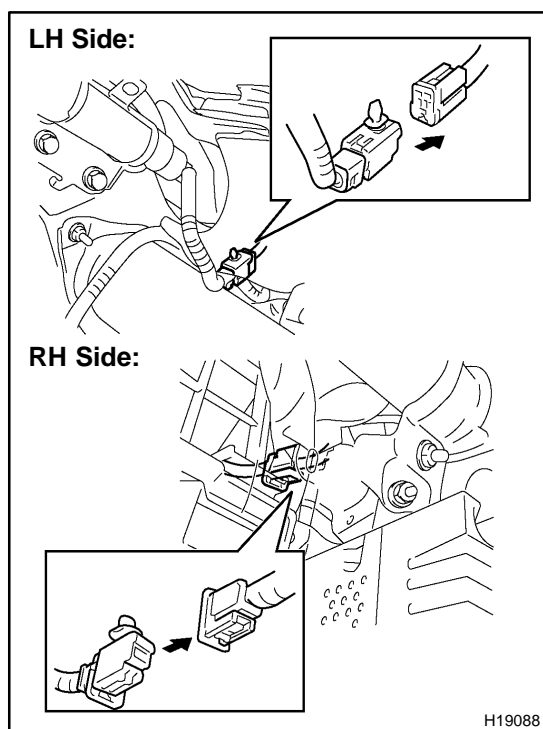

4. REMOVE CURTAIN SHIELD AIRBAG ASSEMBLY

- (a) Disengage the clamp and remove the curtain shield airbag assembly connector.
- (b) Disconnect the connector for curtain sealed airbag assembly.
- (c) Disengage the claw and disconnect the vehicle wire harness from the bracket of the curtain shield airbag assembly.

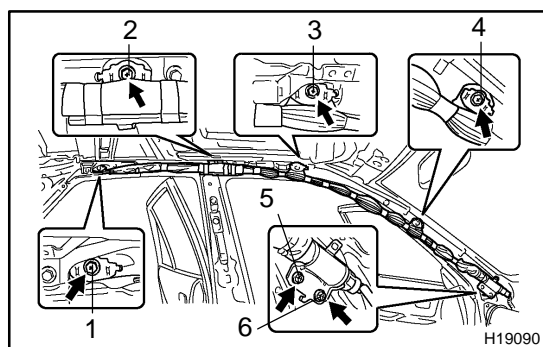

- (d) In the order shown in the illustration, remove the bolts and curtain shield airbag assembly.

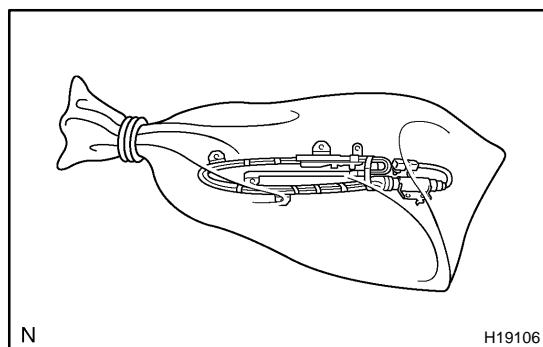

- (e) Put the removed curtain shield airbag assembly into a clear plastic bag and keep it in a safe place.

CAUTION:

Never disassemble the curtain shield airbag assembly.

NOTICE:

The protection bag is not reusable.