

INSTALLATION

1. INSTALL FUEL PRESSURE PULSATION DAMPER

- (a) Install the fuel inlet pipe and pulsation damper with 2 new gaskets.

HINT:

Different the gaskets are used for the upper (large side) and lower (small side).

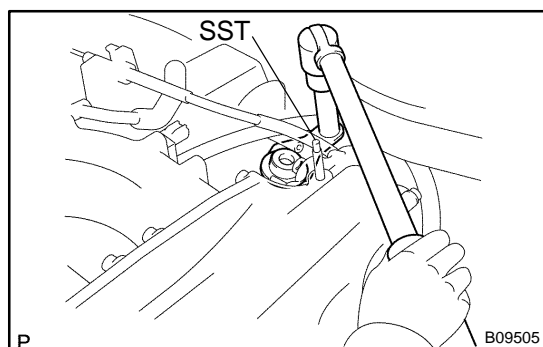

- (b) Using SST, tighten the pulsation damper.

SST 09612-24014 (09617-24011)

Torque: 32.5 N·m (325 kgf·cm, 24 ft·lbf)

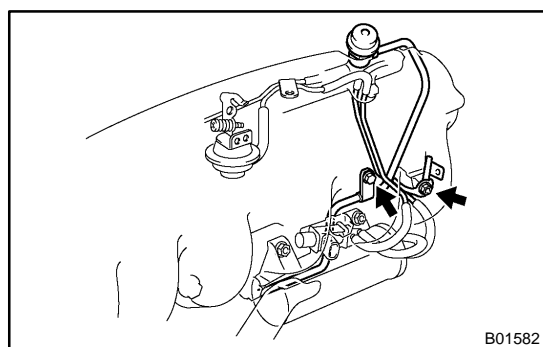

- (c) Install the bolt holding the fuel inlet pipe to the intake manifold.

Torque: 9.0 N·m (90 kgf·cm, 80 in.-lbf)

- (d) Install the nut holding the No. 2 vacuum pipe to the intake manifold.

Torque: 21 N·m (210 kgf·cm, 15 ft·lbf)

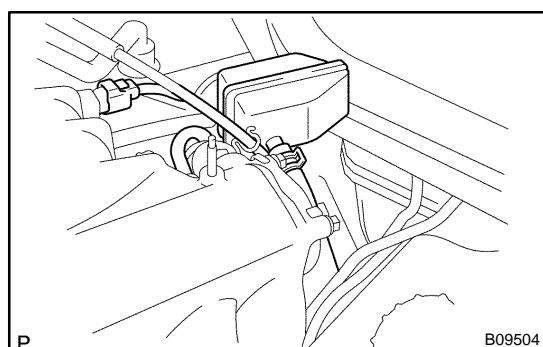

2. CONNECT CONNECTOR AND HOSES

- (a) Connect the vacuum hose (from No. 2 vacuum pipe) to the air intake chamber.
 (b) Connect the EVAP hose to the EVAP pipe.
 (c) Connect the VSV connector for the EVAP.

3. INSTALL ENGINE COVER

Install the engine cover with the 4 nuts.