

INSTALLATION

1. INSTALL TRANSMISSION

- (a) Raise the engine front side.
- (b) Align the input spline with a clutch disc and install the transmission to the engine.

HINT:

Turn the transmission a little in the clockwise and jack up until just before the transmission housing touches the body.

- (c) Install the transmission and wire harness clamp with the 8 bolts.

Torque:

Bolt A (12 mm head bolt):

71.6 N·m (730 kgf·cm, 53 ft·lbf)

Bolt B (10 mm head bolt):

37.3 N·m (380 kgf·cm, 28 ft·lbf)

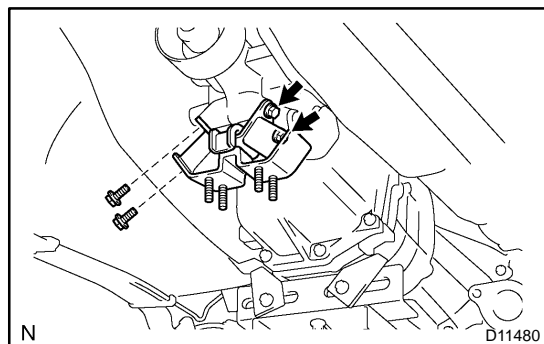

2. INSTALL ENGINE REAR MOUNTING

Install the engine rear mounting with 4 the bolts.

Torque: 25.5 N·m (260 kgf·cm, 19 ft·lbf)

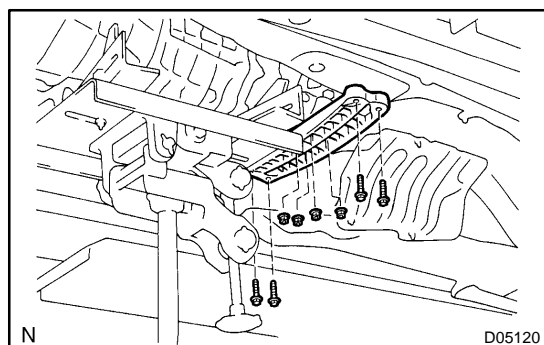

3. INSTALL REAR ENGINE MOUNTING MEMBER

Install the rear engine mounting member with the 4 bolts and 4 nuts.

Torque:

Bolt: 25 N·m (255 kgf·cm, 18 ft·lbf)

Nut: 13.5 N·m (138 kgf·cm, 10 ft·lbf)

4. INSTALL STARTER

- (a) Install the starter with the 2 bolts.
Torque: 37.3 N·m (380 kgf·cm, 28 ft·lbf)
- (b) Install the wire with the nut.
Torque: 9.8 N·m (10 kgf·cm, 7 ft·lbf)
- (c) Connect the connector.

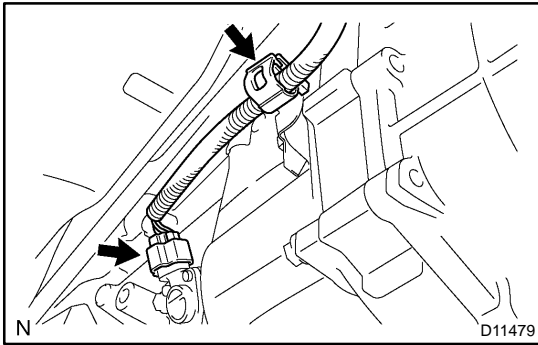

5. CONNECT SPEED SENSOR CONNECTOR AND WIRE HARNESS

- (a) Connect the wire harness to the clamp.
- (b) Connect the connector.

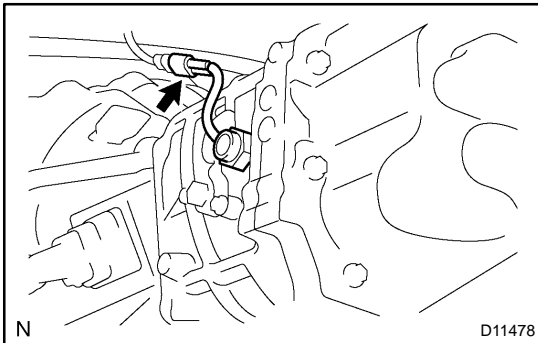

6. CONNECT BACK-UP LIGHT SWITCH CONNECTOR

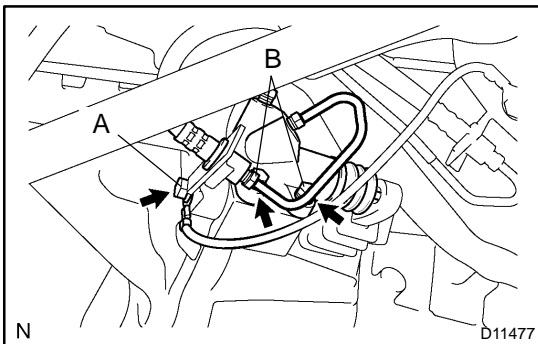

7. CONNECT CLUTCH RELEASE CYLINDER, CLUTCH LINE BRACKET AND EARTH WIRE

- (a) Connect the clutch line and earth wire with the bolt.

Torque:

Bolt A: 37.3 N·m (380 kgf·cm, 28 ft·lbf)

- (b) Connect the clutch release cylinder with the 2 bolts.

Torque:

Bolt B: 11.7 N·m (119 kgf·cm, 9 ft·lbf)

8. INSTALL PROPELLER SHAFT (See page [PR-10](#))

9. INSTALL FRONT AND CENTER EXHAUST PIPES (See page [EM-100](#))

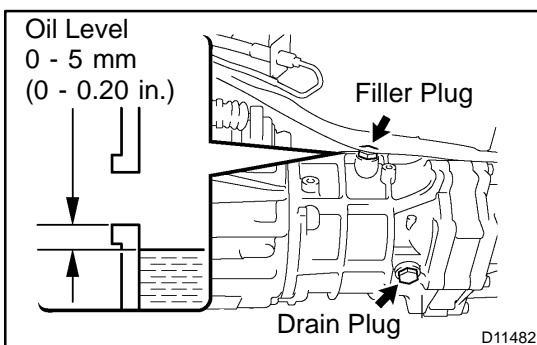

10. FILL WITH TRANSMISSION OIL

Torque:

Filler and Drain plug:

38 N·m (387 kgf·cm, 28 ft·lbf)

Oil grade: API GL-4 or GL-5

Viscosity: SAE 75W-90

Capacity: 2.6 liter (2.7 US qts, 2.3 Imp. qts)

11. INSTALL NO. 1 REAR FLOOR BOARD

12. INSTALL LH FRONT FLOOR CENTER COVER

13. LOWER VEHICLE

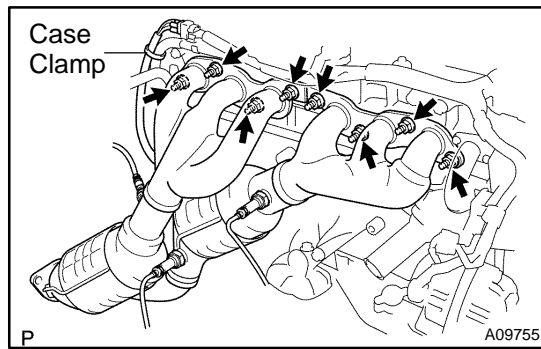
**14. INSTALL EXHAUST MANIFOLD**

- (a) Install 2 new gaskets to the cylinder head.
- (b) Install the exhaust manifold with the 8 nuts. Uniformly tighten the nuts in several passes.
Torque: 40 N·m (408 kgf-cm, 29 ft-lbf)
- (c) Connect the heated oxygen sensor (bank 2 sensor 1) connector.
- (d) Install the case clamp.

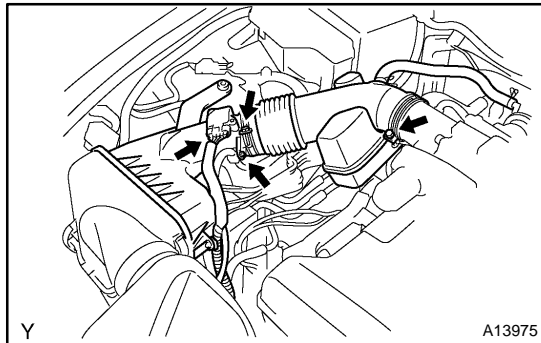
**15. INSTALL INTAKE AIR CONNECTOR**

- (a) Install the intake air resonator to the throttle body, tighten the 2 hose clamp bolts.
- (b) Connect the PCV hose to the No. 2 cylinder head cover.
- (c) Connect the engine wire harness clamp to the air cleaner case.
- (d) Connect the MAF meter connector.

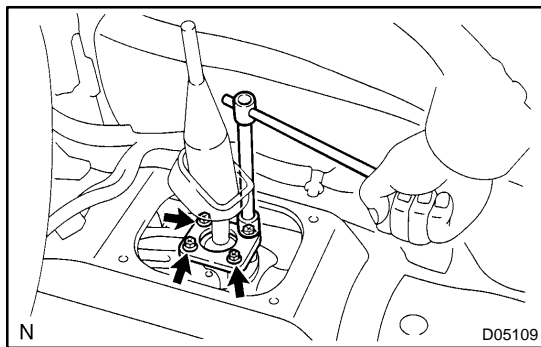
16. CONNECT RADIATOR UPPER HOSE NO. 1 FROM ENGINE**17. FILL WITH ENGINE COOLANT****18. INSTALL ENGINE COVER NO. 1****Torque: 5.0 N·m (51 kgf-cm, 44 in.-lbf)****19. INSTALL NO. 1 AND NO. 2 ENGINE UNDER COVERS****20. INSTALL TRANSMISSION SHIFT LEVER**

- (a) Install the washer.
- (b) Apply MP grease to the tip of shift lever.
- (c) Install the shift lever with the 4 bolts.

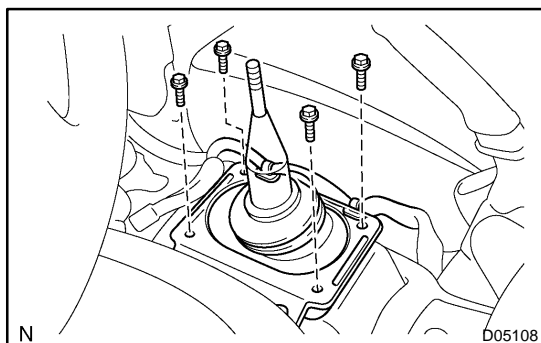
Torque: 8.0 N·m (82 kgf-cm, 71 in.-lbf)**21. INSTALL SHIFT BOOT****22. INSTALL SHIFT BOOT RETAINER**

- (a) Install the shift boot retainer with the 4 bolts.
- (b) Connect the 2 wire harness clamps.

23. INSTALL UPPER CONSOLE PANEL AND CONSOLE BOX (See page [BO-149](#))**24. DO ROAD TEST**

Check for abnormal noises and smooth shifting.