

REMOVAL

1. REMOVE UPPER CONSOLE PANEL AND CONSOLE BOX (See page [BO-139](#))

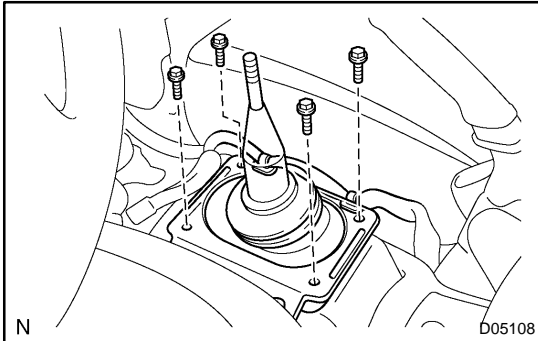

2. REMOVE SHIFT BOOT RETAINER
 - (a) Disconnect the 2 wire harness clamps.
 - (b) Remove the 4 bolts and shift boot retainer.
3. REMOVE SHIFT BOOT

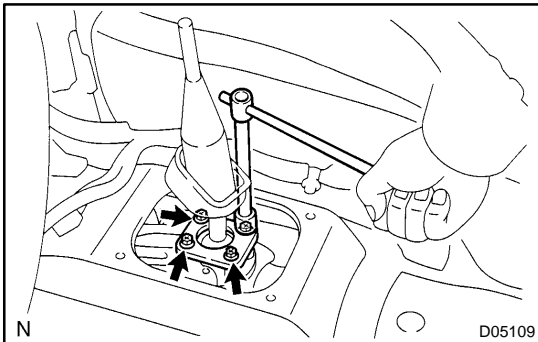

4. REMOVE TRANSMISSION SHIFT LEVER

Remove the 4 bolts, transmission shift lever and washer washer.
5. REMOVE ENGINE COVER NO. 1
6. REMOVE NO. 1 AND NO. 2 ENGINE UNDER COVERS
7. DRAIN ENGINE COOLANT
8. DISCONNECT RADIATOR UPPER HOSE NO. 1 FROM ENGINE

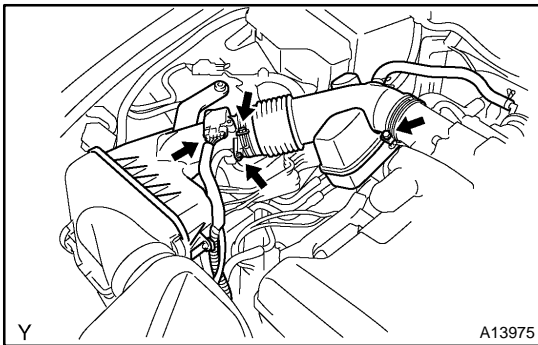

9. REMOVE INTAKE AIR CONNECTOR
 - (a) Disconnect the MAF meter connector.
 - (b) Disconnect the engine wire harness clamp from the air cleaner case.
 - (c) Loosen the 2 hose clamp bolts, remove the intake air connector from the throttle body.

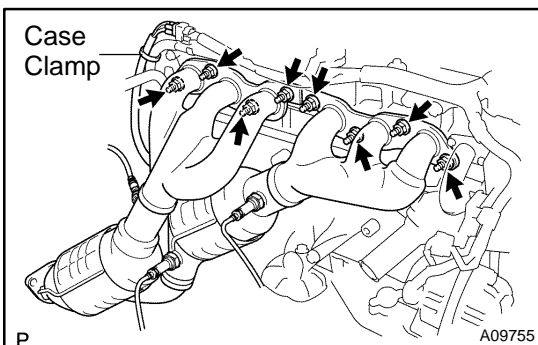

10. REMOVE EXHAUST MANIFOLD
 - (a) Remove the case clamp.
 - (b) Disconnect the heated oxygen sensor (bank 2 sensor 1) connector.
 - (c) Remove the 8 nuts, exhaust manifold and 2 gaskets.
11. RAISE VEHICLE

NOTICE:

Make sure that the vehicle is securely supported.

12. DRAIN TRANSMISSION OIL

13. REMOVE LH FRONT FLOOR CENTER COVER
14. REMOVE NO. 1 REAR FLOOR BOARD
15. REMOVE FRONT AND CENTER EXHAUST PIPES
(See page [EM-100](#))
16. REMOVE PROPELLER SHAFT (See page [PR-4](#))

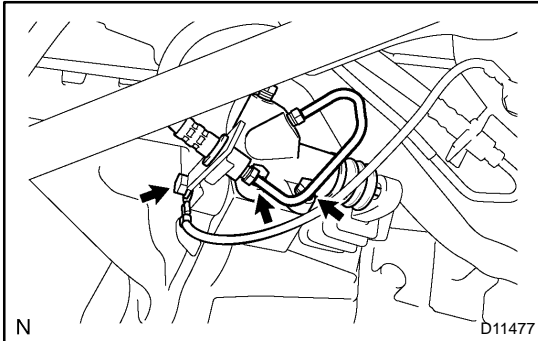

17. **DISCONNECT CLUTCH RELEASE CYLINDER, CLUTCH LINE BRACKET AND EARTH WIRE**
 - (a) Remove the 2 bolts and disconnect the clutch release cylinder.
 - (b) Remove the bolt and disconnect the clutch line bracket and earth wire.

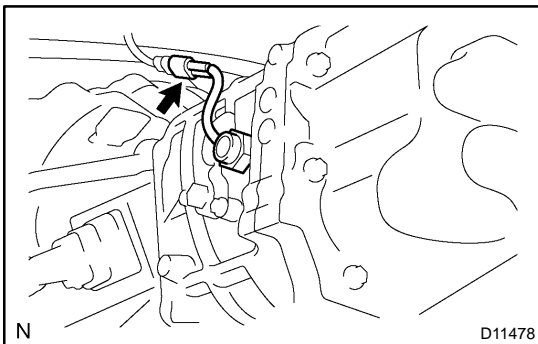

18. **DISCONNECT BACK-UP LIGHT SWITCH CONNECTOR**

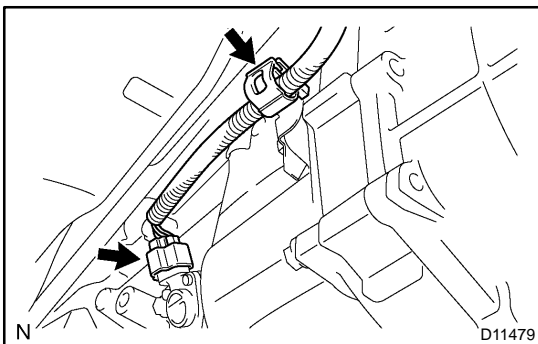

19. **DISCONNECT SPEED SENSOR CONNECTOR AND WIRE HARNESS**

- (a) Disconnect the connector.
- (b) Disconnect the wire harness from the clamp.

20. **REMOVE STARTER**

- (a) Disconnect the connector.
- (b) Remove the nut and wire.
- (c) Remove the 2 bolts and starter.

21. **JACK UP TRANSMISSION SLIGHTLY**

Using a transmission jack, support the transmission.

22. **REMOVE REAR ENGINE MOUNTING MEMBER**

Remove the 4 bolts, 4 nuts and rear engine mounting member.

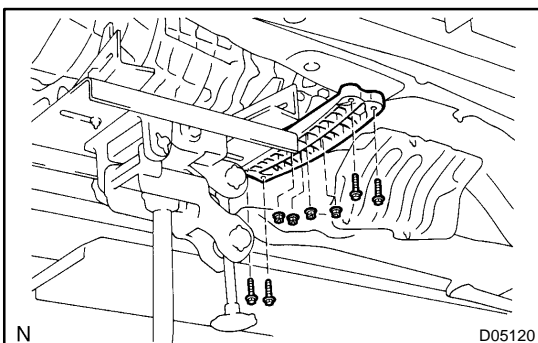

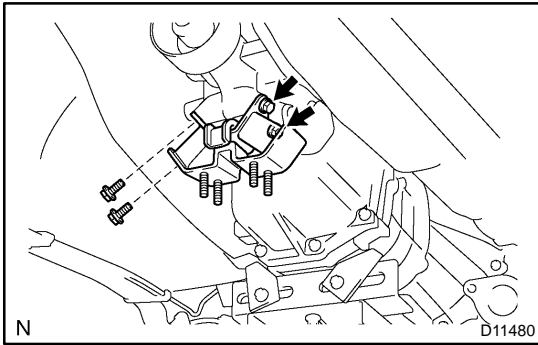
**23. REMOVE ENGINE REAR MOUNTING**

Remove the 4 bolts and engine rear mounting.

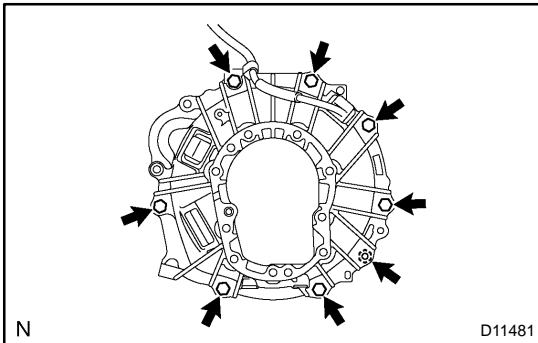
**24. REMOVE TRANSMISSION**

Remove the 8 bolts, wire harness clamp and transmission.

HINT:

After separating the transmission from the engine, turn the transmission a little in the clockwise. At the condition that the transmission housing does not contact the body, lower the jack.