

## INSTALLATION

### 1. INSTALL OIL PUMP

- Place 2 new O-rings in position on the cylinder block.
- Remove any old packing (FIPG) material and be careful not to drop any oil on the contact surfaces of the oil pump and cylinder block.
  - Using a razor blade gasket scraper, remove all the old packing (FIPG) material from the gasket surfaces and sealing groove.
  - Thoroughly clean all components to remove all the debris.
  - Using a non-residue solvent, clean both sealing surfaces.

#### NOTICE:

**Do not use a solvent which will affect the painted surfaces.**

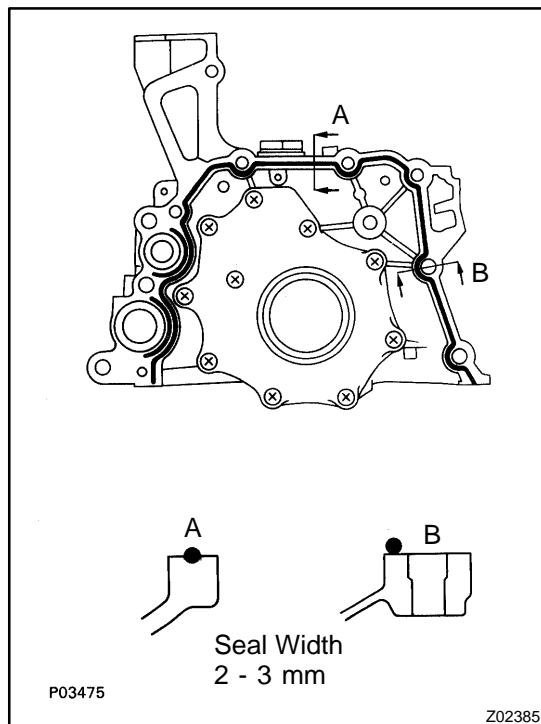

- Apply seal packing to the oil pump as shown in the illustration.

#### Seal packing: Part No.08826-00080 or equivalent

- Install a nozzle that has been cut to a 2 - 3 mm (0.08 - 0.12 in.) opening.

#### HINT:

Avoid applying an excessive amount to the surface. Be particularly careful near oil passages.

- Parts must be assembled within 5 minutes of application. Otherwise the material must be removed and reapplied.
- Immediately remove nozzle from the tube and reinstall cap.

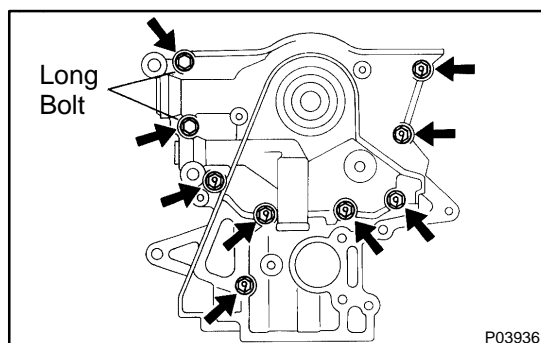

- Install the oil pump with the 9 bolts.  
**Torque: 21 N·m (210 kgf-cm, 15 ft-lbf)**

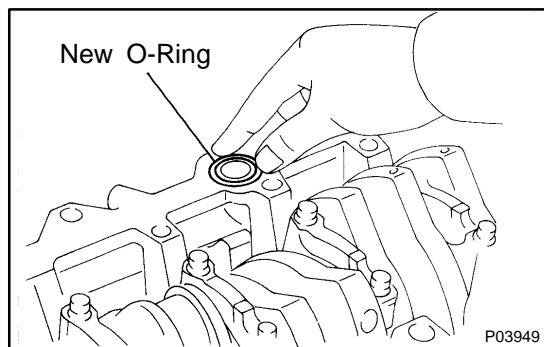

## 2. INSTALL NO. 1 OIL PAN

- (a) Place a new O-ring in the position on the cylinder block.
- (b) Remove any old packing (FIPG) material and be careful not to drop any oil on the contact surfaces of the No. 1 oil pan and cylinder block.
  - Using a razor blade and gasket scraper, remove all the old packing (FIPG) material from the gasket surfaces and sealing groove.
  - Thoroughly clean all components to remove all the debris.
  - Using a non-residue solvent, clean both sealing surfaces.

### NOTICE:

**Do not use a solvent which will affect the painted surfaces.**

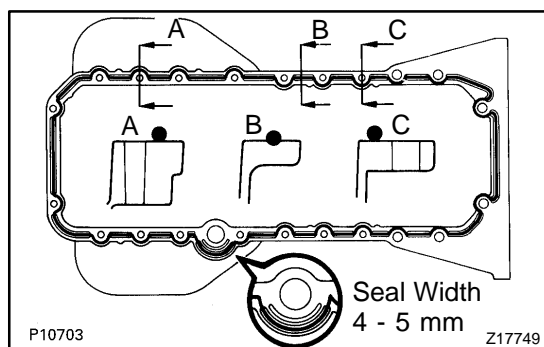

- (c) Apply seal packing to the No. 1 oil pan as shown in the illustration.

### Seal packing: Part No.08826-00080 or equivalent

- Install a nozzle that has been cut to a 4 - 5 mm (0.16 - 0.20 in.) opening.

### HINT:

Avoid applying an excessive amount to the surface.

- Parts must be assembled within 5 minutes of application. Otherwise the material must be removed and reapplied.
- Immediately remove nozzle from the tube and reinstall cap.

- (d) Install the No.1 oil pan with the 22 bolts.

### Torque:

**21 N·m (210 kgf·cm, 15 ft·lbf) for 12 mm head**  
**40 N·m (400 kgf·cm, 30 ft·lbf) for 14 mm head**

## 3. INSTALL OIL PAN BAFFLE PLATE

**Torque: 9.0 N·m (90 kgf·cm, 80 in.-lbf)**

## 4. INSTALL OIL STRAINER

Install a new gasket and the oil strainer with the bolt and 2 nuts.

**Torque: 9.0 N·m (90 kgf·cm, 80 in.-lbf)**

## 5. INSTALL NO. 2 OIL PAN

- (a) Remove any old packing (FIPG) material and be careful not to drop any oil on the contact surfaces of the No. 1 and No. 2 oil pans.
  - Using a razor blade and gasket scraper, remove all the old packing (FIPG) material from the gasket surfaces and sealing groove.
  - Thoroughly clean all components to remove all the debris.

- Using a non-residue solvent, clean both sealing surfaces.

**NOTICE:**

**Do not use a solvent which will affect the painted surfaces.**

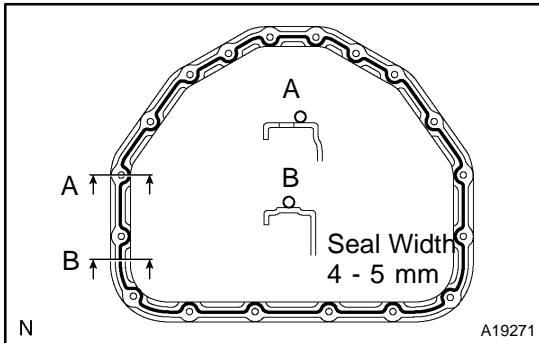

- (b) Apply seal packing to the No. 2 oil pan as shown in the illustration.

**Seal packing: Part No.08826-00080 or equivalent**

Install a nozzle that has been cut to a 4 - 5 mm (0.16 - 0.20 in.) opening.

**HINT:**

Avoid applying an excessive amount to the surface.

- Parts must be assembled within 5 minutes of application. Otherwise the material must be removed and reapplied.
  - Immediately remove nozzle from the tube and reinstall cap.
- (c) Install the No. 2 oil pan with the 16 bolts and 2 nuts.  
**Torque: 9.0 N·m (90 kgf·cm, 80 in.-lbf)**

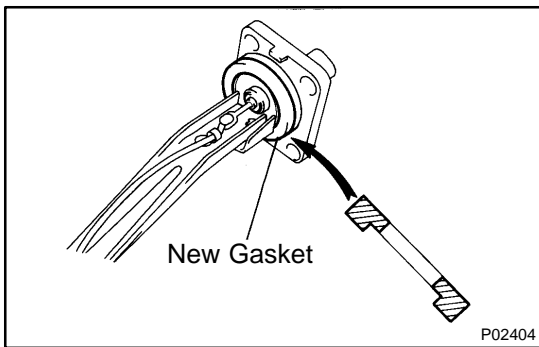
**6. INSTALL OIL LEVEL SENSOR**

- (a) Install a new gasket to the level sensor.  
(b) Install the level sensor with the 4 bolts.  
**Torque: 5.4 N·m (55 kgf·cm, 48 in.-lbf)**  
(c) Connect the level sensor connector.

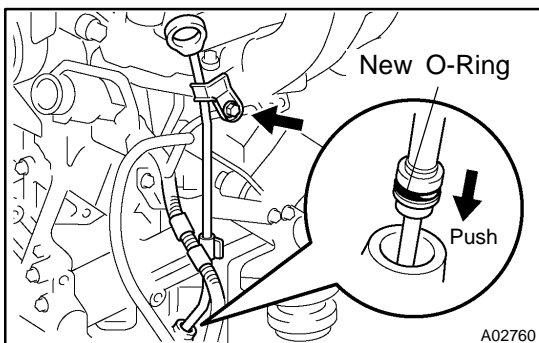
**7. INSTALL OIL DIPSTICK GUIDE AND DIPSTICK**

- (a) Install a new O-ring on the dipstick guide.  
(b) Apply soapy water on the O-ring.  
(c) Push in the dipstick guide into the guide hole of the No. 1 oil pan.  
(d) Install the dipstick guide with the bolt.  
(e) Install the dipstick.  
(f) Connect the engine wire clamp to the dipstick guide.

**8. INSTALL CRANKSHAFT TIMING PULLEY, IDLER PULLEY AND TIMING BELT (See page EM-24 )**

9. **INSTALL CRANKSHAFT POSITION SENSOR**  
Torque: 9.0 N·m (90 kgf·cm, 80 in.-lbf)
10. **REMOVE ENGINE STAND FROM ENGINE**
11. **ASSEMBLY ENGINE AND TRANSMISSION (See page [EM-71](#) )**
12. **INSTALL ENGINE WITH TRANSMISSION (See page [EM-71](#) )**