

REMOVAL

HINT:

A bolt without a torque specification is shown in the standard bolt chart. (see page [SS-2](#))

1. REMOVE INSIDE HANDLE BEZEL

- (a) Using a screwdriver, open the screw cap.

HINT:

Tape the screwdriver tip before use.

- (b) Remove the screw.

- (c) Using a screwdriver, remove the inside handle bezel as shown in the illustration.

HINT:

Tape the screwdriver tip before use.

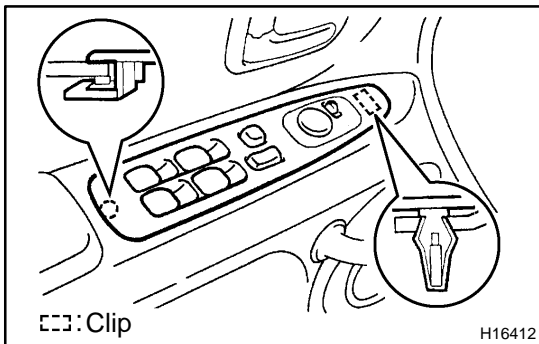

2. REMOVE POWER WINDOW SWITCH

- (a) Using a screwdriver, remove the power window switch.

HINT:

Tape the screwdriver tip before use.

- (b) Disconnect the connectors.

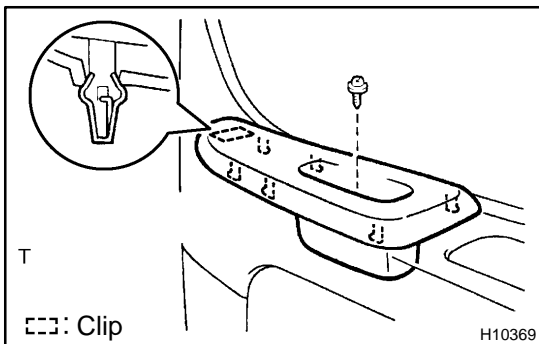

3. REMOVE FRONT ARMREST

- (a) Remove the screw.

- (b) Using a screwdriver, remove the front armrest as shown in the illustration.

HINT:

Tape the screwdriver tip before use.

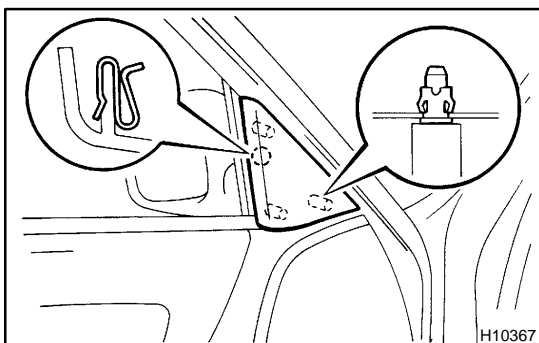

4. REMOVE LOWER FRAME BRACKET GARNISH

Remove the lower frame bracket garnish.

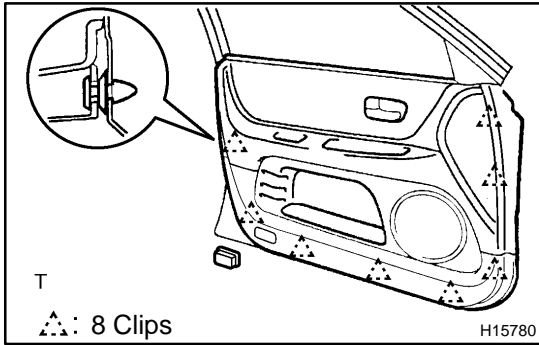

5. REMOVE DOOR TRIM

- (a) Using a screwdriver, remove the courtesy light, then disconnect the connector.

HINT:

Tape the screwdriver tip before use.

- (b) Using a screwdriver, disengage the clips, then pull the trim upward to remove it.

HINT:

Tape the screwdriver tip before use.

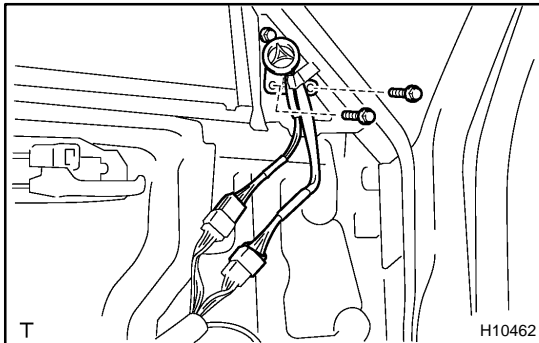

6. REMOVE FRONT NO.2 SPEAKER

- (a) Disconnect the connector.
- (b) Remove the 2 bolts and front No.2 speaker.

7. REMOVE OUTSIDE REAR VIEW MIRROR

- (a) Disconnect the connector.
- (b) Remove the bolt and outside rear view mirror.