

REMOVAL

HINT:

A bolt without a torque specification is shown in the standard bolt chart. (see page [SS-2](#))

1. **REMOVE FRONT SEAT**
(See page [BO-173](#) and [BO-185](#))
2. **Sedan Type:**
REMOVE REAR SEAT CUSHION (See page [BO-204](#))
3. **Wagon Type:**
REMOVE REAR SEAT CUSHION (See page [BO-204](#))

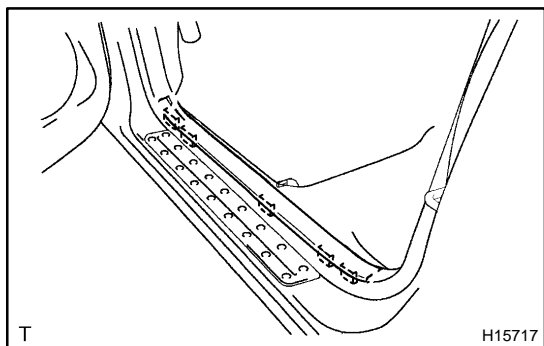

4. REMOVE FRONT DOOR INSIDE SCUFF PLATE

- (a) Using a screwdriver, remove the front door inside scuff plate.

HINT:

Tape the screwdriver tip before use.

- (b) Employ the same manner described above to the other side.

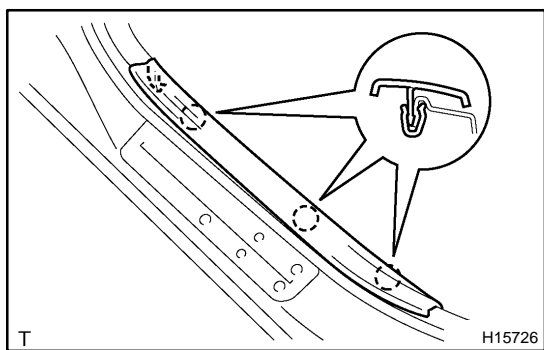

5. REMOVE REAR DOOR INSIDE SCUFF PLATE

- (a) Using a screwdriver, remove the rear door inside scuff plate.

HINT:

Tape the screwdriver tip before use.

- (b) Employ the same manner described above to the other side.

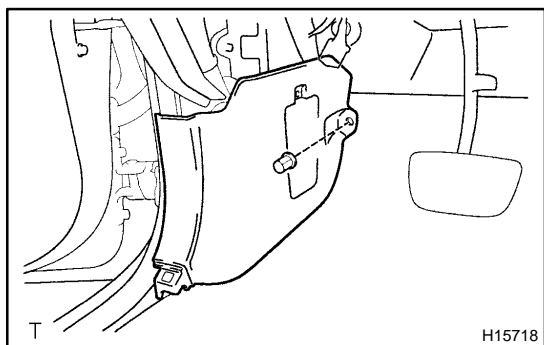

6. REMOVE COWL SIDE TRIM BOARD

- (a) Remove the clip and cowl side trim board.
- (b) Employ the same manner described above to the other side.

7. REMOVE FRONT DOOR OPENING TRIMS

8. REMOVE REAR DOOR OPENING TRIMS

9. REMOVE FRONT SEAT OUTER BELT FLOOR ANCHORS

- (a) Using a screwdriver, remove the floor anchor cover caps.

HINT:

Tape the screwdriver tip before use.

- (b) Remove the 2 bolts and floor anchors.

Torque: 41 N·m (420 kgf-cm, 30 ft-lbf)

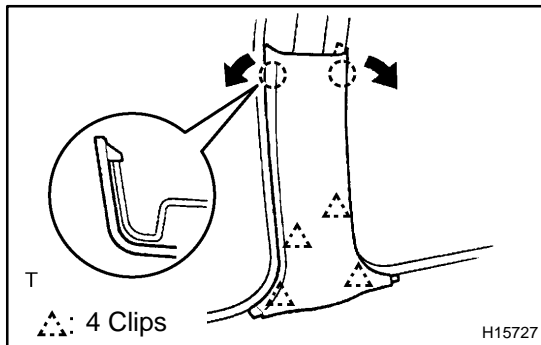

10. REMOVE CENTER PILLAR LOWER GARNISH

- (a) Remove the center pillar lower garnish as shown in the illustration.

- (b) Employ the same manner described above to the other side.

11. M/T:

REMOVE SHIFT LEVER KNOB

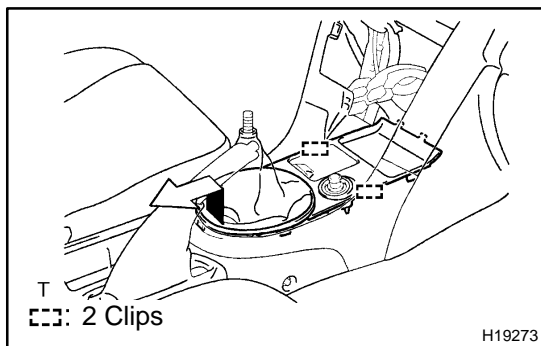

12. REMOVE UPPER CONSOLE PANEL

- (a) M/T:

Remove the shift lever knob.

- (b) Using a screwdriver, remove the upper console panel as shown in the illustration.

HINT:

Tape the screwdriver tip before use.

- (c) Disconnect the connector.

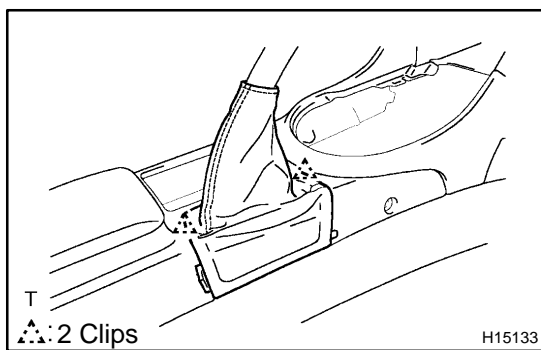

13. REMOVE PARKING BRAKE HOLE COVER

Using a screwdriver, remove the parking brake hole cover.

HINT:

Tape the screwdriver tip before use.

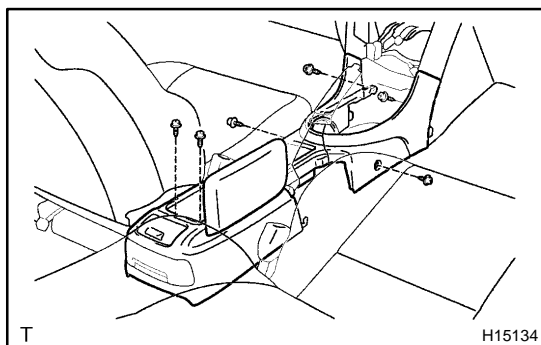

14. w/o Arm Rest:

REMOVE CONSOLE BOX

- (a) Remove the 6 screws.

- (b) w/o LEXUS navigation system:

Pull the console box rearward to remove it.

- (c) w/ LEXUS navigation system:

Pull the console box rearward to remove it, then disconnect the connector.

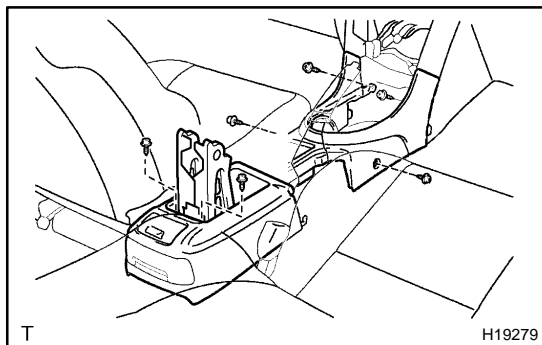
**15. w/ Arm Rest:****REMOVE CONSOLE BOX**

- (a) Using a screwdriver, remove the box side No.1 and No.2 panel.

HINT:

Tape the screwdriver tip before use.

- (b) Remove the 2 bolts and console compartment door.
 (c) Remove the console box cover rear.
 (d) Remove the 6 screws.
 (e) w/o LEXUS navigation system:
 Pull the console box rearward to remove it.
 (f) w/ LEXUS navigation system:
 Pull the console box rearward to remove it, then disconnect the connector.

16. REMOVE FOOT REST

- (a) Sports pedal type:
 Remove the 4 screws and foot rest trim.

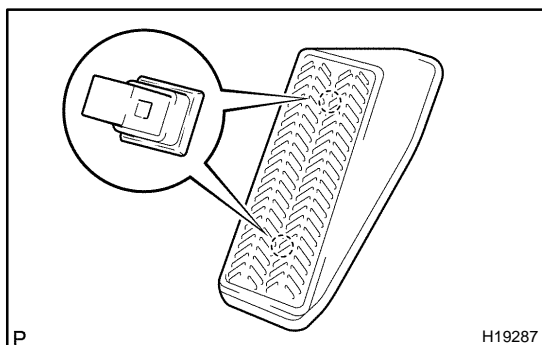

- (b) Using a screwdriver, remove the foot rest as shown in the illustration.

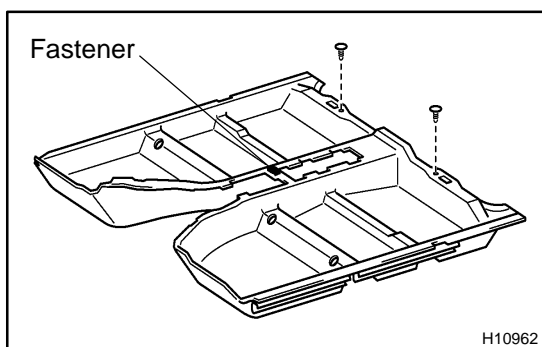
**17. REMOVE FLOOR CARPET**

- (a) Peel off the fastener.
 (b) Remove the 2 clips.
 (c) Disengage the hooks and remove the floor carpet.

NOTICE:

Be careful not to pull the wire harness.

HINT:

At the time of installation, please refer to the following items.

- When installing the floor mat, pull out the wire harness and levers through the cutout of the floor carpet.
- There should be no wrinkles or folds after attaching the floor carpet.