

INSPECTION

1. w/ Sliding Roof: INSPECT FRONT PERSONAL LIGHT SWITCH CONTINUITY

Switch position	Tester connection	Specified condition
OFF	-	No continuity
ON	1 - 4	Continuity

If continuity is not as specified, replace the light assembly or bulb.

2. w/o Sliding Roof: INSPECT FRONT PERSONAL LIGHT SWITCH CONTINUITY

Switch position	Tester connection	Specified condition
OFF	-	No continuity
ON	1 - 2	Continuity

If continuity is not as specified, replace the light assembly or bulb.

3. INSPECT FRONT PERSONAL LIGHT SWITCH CIRCUIT (See page [DI-907](#))

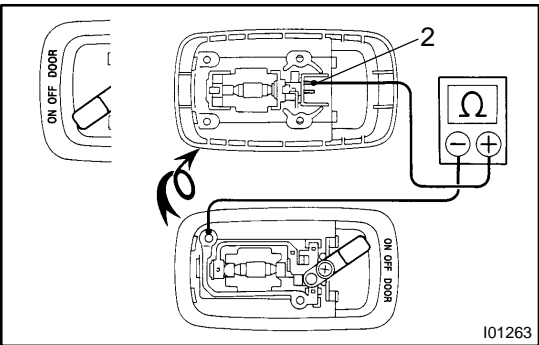

4. w/o Reader sensor: INSPECT ROOM LIGHT CONTINUITY

- (a) Disconnect the connector from the room light.
- (b) Turn the room light switch ON, check that continuity exists between terminal 2 and body ground.

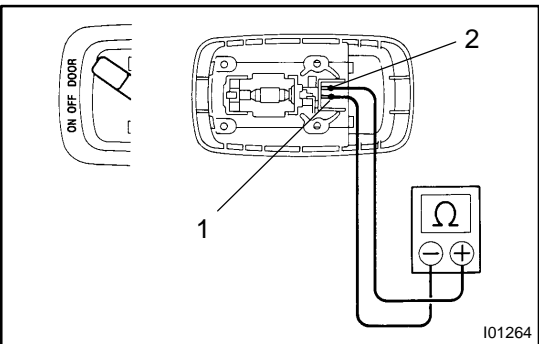

- (c) Turn the room light switch DOOR, check that continuity exists between terminals 1 and 2.

If continuity is not as specified, replace the light assembly or bulb.

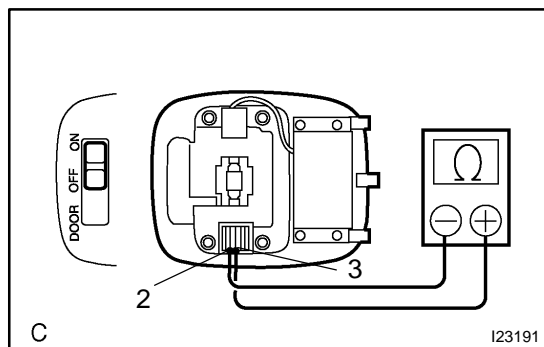

5. w/ Reader sensor:

INSPECT ROOM LIGHT CONTINUITY

- (a) Disconnect the connector from the room light.
- (b) Turn the room light switch ON, check that continuity exists between terminal 2 and 3.

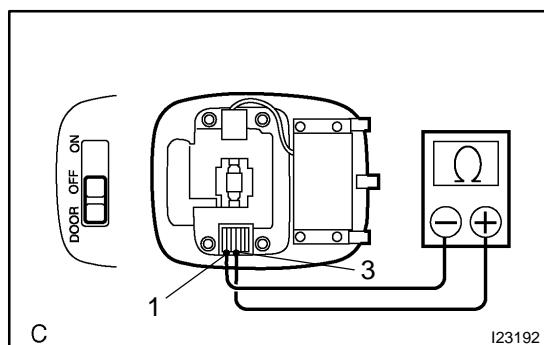

- (c) Turn the room light switch DOOR, check that continuity exists between terminals 1 and 3.

If continuity is not as specified, replace the light assembly or bulb.

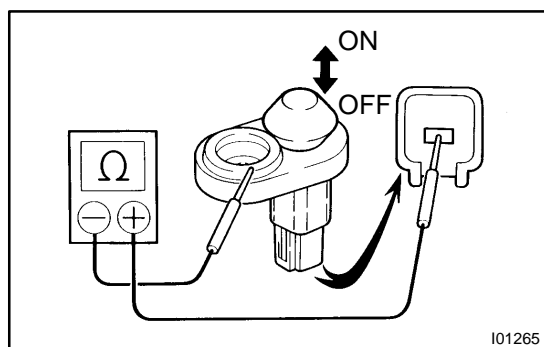

6. INSPECT FRONT DOOR COURTESY SWITCH CONTINUITY

- (a) Check that continuity exists between terminals and the switch body with the switch ON (switch pin released: opened door).
- (b) Check that no continuity exists between terminals and the switch body with the switch OFF (switch pin pushed in: closed door).

If operation is not as specified, replace the switch.

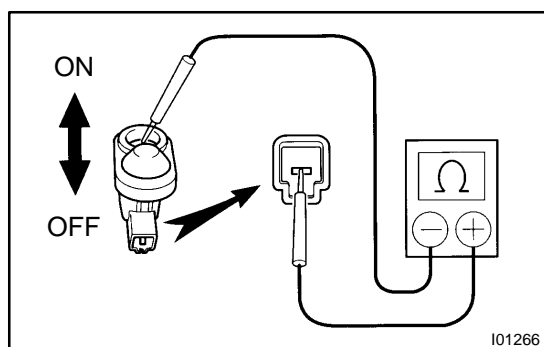

7. INSPECT REAR DOOR COURTESY SWITCH CONTINUITY

- (a) Check that continuity exists between terminals and the switch body with the switch ON (switch pin released: opened door).
- (b) Check that no continuity exists between terminals and the switch body with the switch OFF (switch pin pushed in: closed door).

If operation is not as specified, replace the switch.

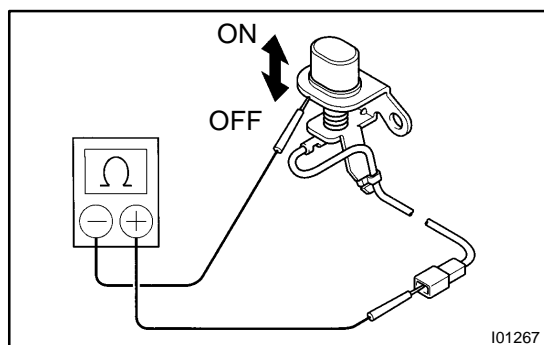

8. INSPECT LUGGAGE COMPARTMENT DOOR COURTESY SWITCH CONTINUITY

- (a) Check that continuity exists between terminals and the switch body with the switch ON (switch pin released: opened door).
- (b) Check that no continuity exists between terminals and the switch body with the switch OFF (switch pin pushed in: closed door).

If operation is not as specified, replace the switch.

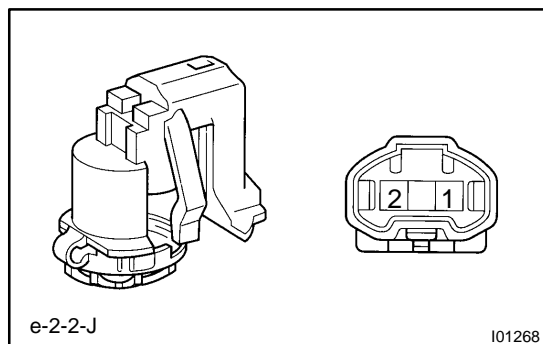

9. INSPECT LUGGAGE COMPARTMENT LIGHT CONTINUITY

Using the ohmmeter, check that continuity exists between terminals.

If continuity is not as specified, replace the light assembly or bulb.

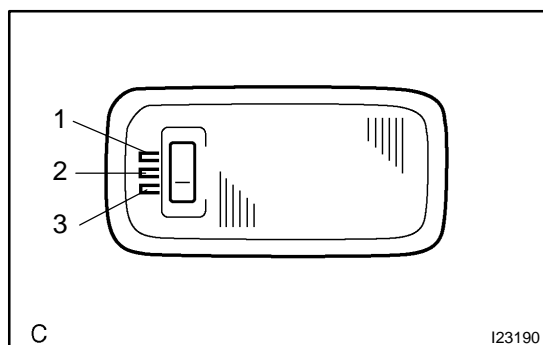

10. REAR ROOM LIGHT SWITCH CONTINUITY

Switch position	Tester connection	Specified condition
OFF	1 - 2	No continuity
ON	2 - 3	Continuity

If continuity is not as specified, replace the light assembly or bulb.

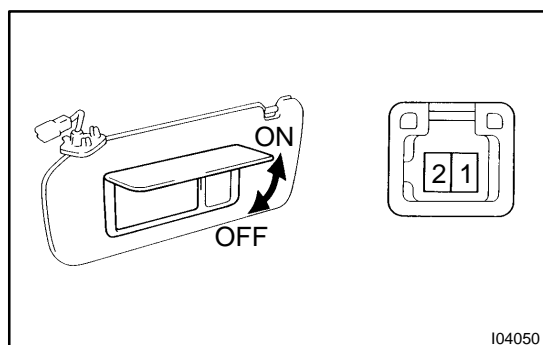

11. INSPECT VANITY LIGHT CONTINUITY

Switch position	Tester connection	Specified condition
OFF (closed)	-	No continuity
ON (opened)	1 - 2	Continuity

If continuity is not as specified, replace the vanity light assembly or bulb.

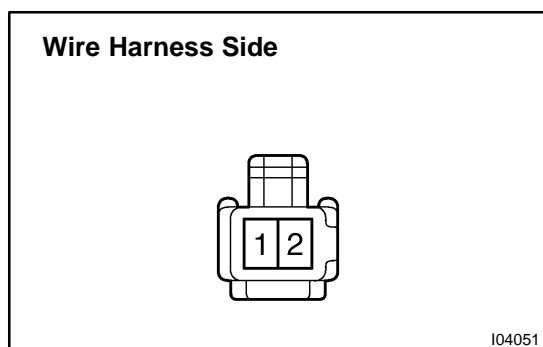

12. INSPECT VANITY LIGHT CIRCUIT (See page [DI-907](#))

Disconnect the connector from the light and inspect the connector on the wire harness side, as shown.

Tester connection	Condition	Specified condition
2 - Ground	Always	Continuity
1 - Ground	Always	Battery Positive Voltage

If circuit is not as specified, inspect power source or wire harness.

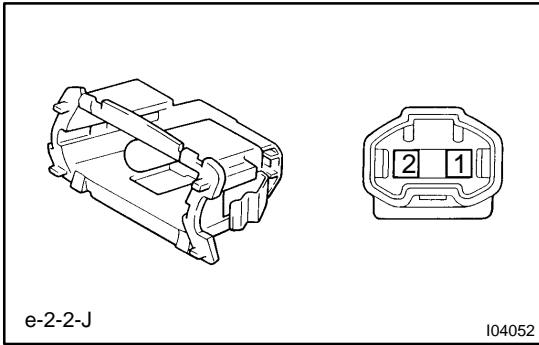

13. INSPECT DOOR COURTESY LIGHT CONTINUITY

Using an ohmmeter, check that continuity exists between terminals.

If continuity is not as specified, replace the light assembly or bulb.

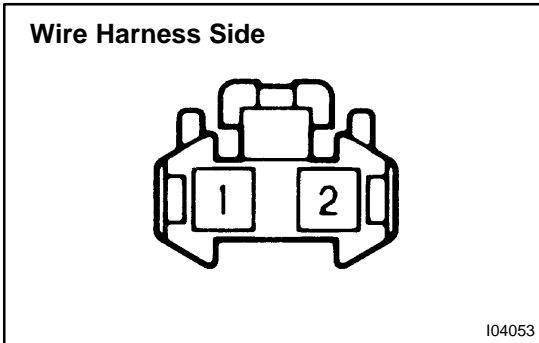

14. INSPECT DOOR COURTESY LIGHT CIRCUIT (See page [DI-907](#))

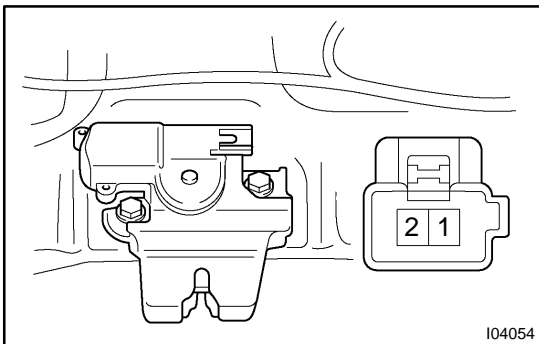

15. INSPECT LUGGAGE COMPARTMENT DOOR COURTESY SWITCH CONTINUITY

Switch position	Tester connection	Specified condition
OFF (closed)	-	No continuity
ON (opened)	2 - Switch body	Continuity

If continuity is not as specified, replace the switch.

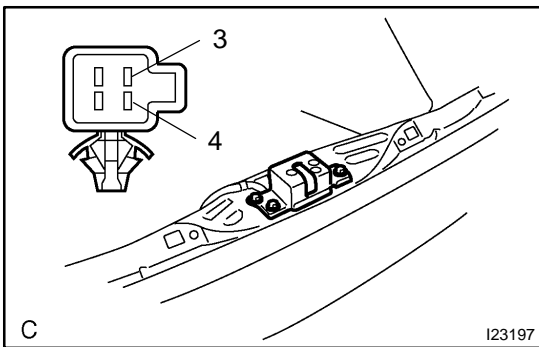

16. BACK DOOR COURTESY SWITCH CONTINUITY

Switch position	Tester connection	Specified condition
OFF (closed)	-	No continuity
ON (opened)	3 - 4	Continuity

If continuity is not as specified, replace the switch.

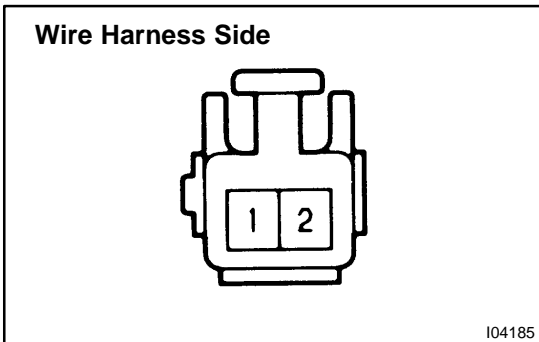

17. INSPECT LUGGAGE COMPARTMENT DOOR COURTESY SWITCH CIRCUIT (See page [DI-923](#))

Disconnect the connector from the switch and inspect the connector on the wire harness side, as shown.

Tester connection	Condition	Specified condition
2 - Body ground	Luggage compartment door courtesy switch ON (door opened)	Continuity

If circuit is not as specified, inspect power source or wire harness.

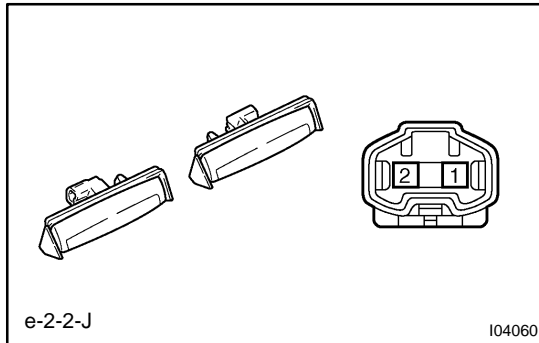

18. INSPECT LICENSE PLATE LIGHT CONTINUITY

Using an ohmmeter, check that continuity exists between terminals.

If continuity is not as specified, replace the light assembly or bulb.

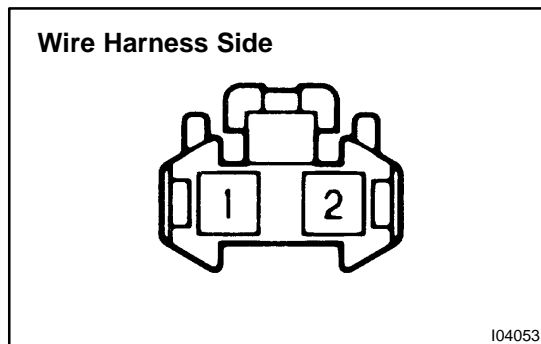

19. INSPECT LICENSE PLATE LIGHT CIRCUIT

Disconnect the connector from the light and inspect the connector on the wire harness side, as shown.

Tester connection	Condition	Specified condition
1 - Ground	Always	Continuity
2 - Ground	Light control switch TAIL or HEAD	Battery Positive Voltage

If circuit is not as specified, inspect power source or wire harness.